

SafirZincir

TRANSMİSYON ZİNCİR KATALOĐU

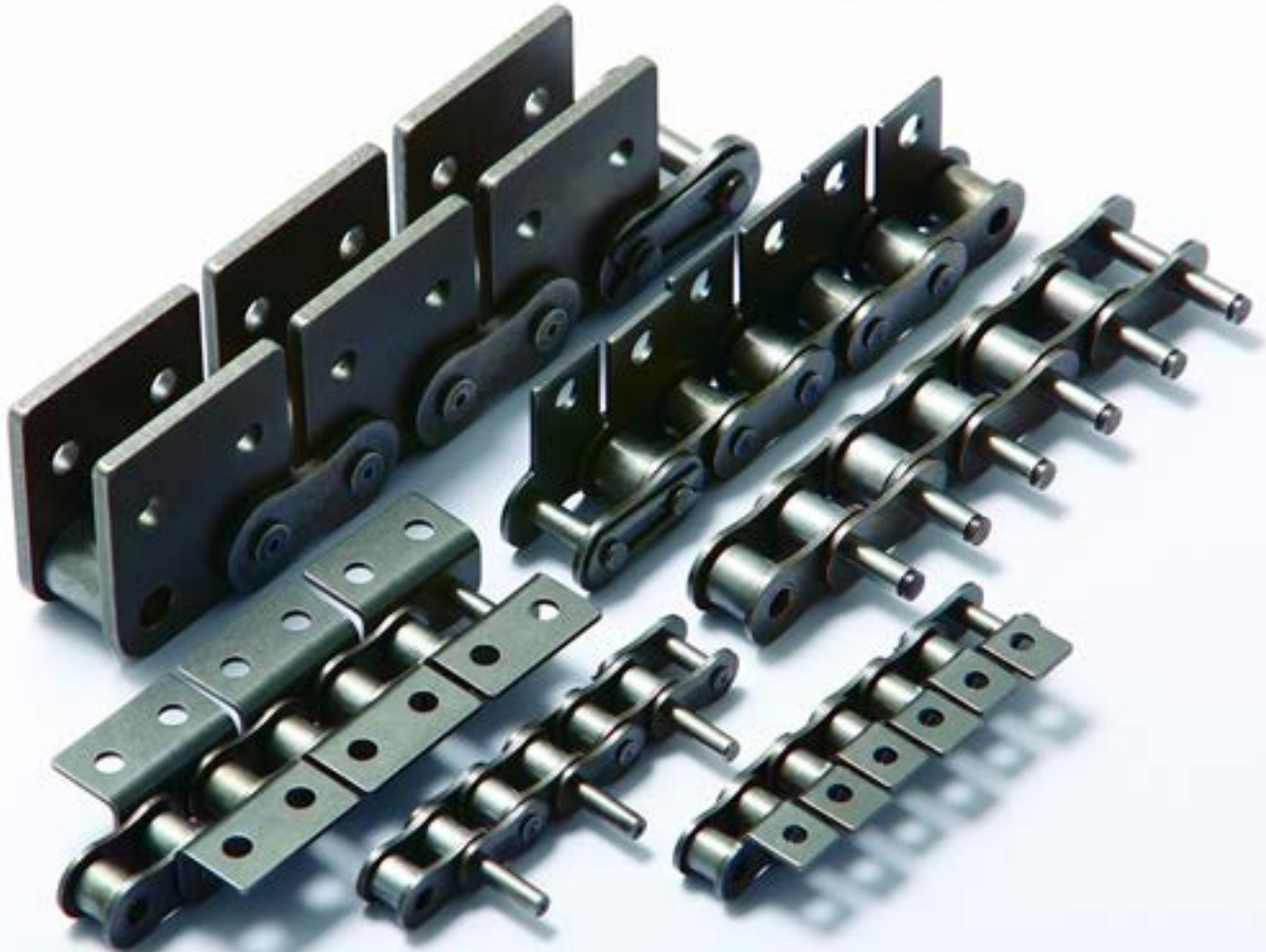

İÇİNDEKİLER

KULLANIM SAHALARI:

Sanayide, ziraatte, otomotiv ve motosikletlerde, plastik, tekstil, kağıt, ambalaj, baskı, demir ve ağaç, inşaat, kimya, şeker, cam, çimento, seramik v.s. makinelerinde.

ZİNCİR ÇEŞİT VE NÖRMLARI

SAYFA

| | |
|--|-------|
| Makaralı Perçinli Mafsallı Tek Sıralı Zincirler B.S | 01 |
| Makaralı Perçinli Mafsallı Zincirler | 02-03 |
| Norm Harici Tek Sıralı Hususi Zincirler | 04-05 |
| Uzun Baklılı Makaralı Zincirler | 06 |
| Makarasız Zincirler | 07 |
| Sabit Burçlu Zincirler | 07 |
| Rotary API Zincirleri | 08 |
| Havai Hat Sistemi-Kulaklı Zincir Sis.-Kilit ve Yarım Bakla Çeşitleri | 09 |
| Varyatör Zincirleri | 10 |
| Galle Zincirleri | 11 |
| Cetvel | 12-13 |
| Dokuma Sanayiinde Kullanılan Zincirler | 14 |
| Dişli-Dişli Kaplinleri-V Kasnakları- Konik Sıkma Burçları | 15 |
| Taşıma Zincirleri | 16 |
| Zirai Transmilyon Zincirleri | 17 |
| Prese Çelikten Zincir Baklıları | 17 |
| Sessiz Zincirler | 18-19 |
| Fleyer Kaldırma Zincirleri | 20 |

MAKARALI PERÇİNLİ MAFSALLI TEK SIRALI ZİNCİRLER B.S.

B.S
BS 228 o DIN 8180-8187
UNI 2578 o NF.-E 26-101

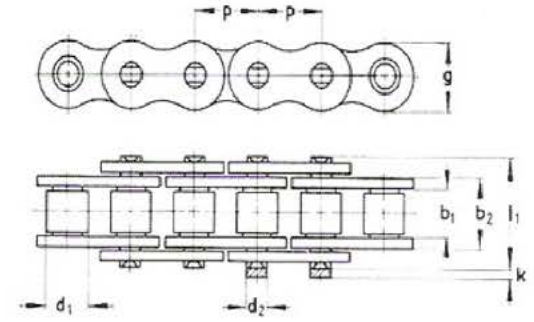

| DIN-ISO Nr. | DIN | Pratik İfade t x b1 | t | | b1 Makara Genişlik mm | d1 Makara Kutu mm | d2 Perçin Kutu mm | B2 Azami Genişlik mm | Siklet kg/mt | Kopma Mukavemeti Kg. |
|----------------|------|------------------------|--------|-------------|--------------------------------|----------------------------|----------------------------|-------------------------------|-----------------|----------------------------|
| | | | inç | Hatve mm | | | | | | |
| | 8180 | 5X2.5 mm | - | 5 | 2.50 | 3.20 | 1.50 | 7.3 | 0.08 | 200 |
| 04-B1 | 8180 | •6X2.8 mm | - | 6 | 2.80 | 4.00 | 1.85 | 7.7 | 0.12 | 300 |
| 05-B1 | 8180 | •8 mmX1/8" | - | 8 | 3.15 | 5.00 | 2.30 | 9.1 | 0.18 | 600 |
| 06-B1 | 8187 | 3/8X1/8" | | | 3.60 | 6.00 | 2.78 | 10.8 | 0.26 | 850 |
| 06-B1 | 8187 | 3/8x5/32" | 3/8" | 9.525 | 3.94 | 6.35 | 3.31 | 12.0 | 0.34 | 1100 |
| 06-B1 | 8187 | •3/8x7/32" | | | 5.90 | 6.35 | 3.31 | 14.0 | 0.41 | 1200 |
| 08-B1 | 8180 | 1/2x1/8" | | | 3.50 | 7.75 | 3.68 | 10.6 | 0.31 | 1100 |
| 08-B1 | 8180 | •1/2x3/16" | | | 4.88 | 7.75 | 3.68 | 12.0 | 0.34 | 1100 |
| 08-B1 | W | •1/2x3/16" | | | 4.88 | 7.75 | 3.68 | 12.8 | 0.38 | 1400 |
| 08-B1 | W | •1/2x3/16" | | | 4.88 | 7.75 | 3.68 | 14.0 | 0.44 | 1550 |
| 08-B1 | W | •1/2x3/16" | 1/2" | 12.7 | 4.88 | 7.75 | 3.68 | 14.0 | 0.44 | 1550 |
| 08-B1 | W | 1/2"x5.2 mm | | | 5.21 | 8.51 | 4.45 | 15. | 0.63 | 2200 |
| 08-B1 | 8187 | •1/2x1/4" | | | 6.40 | 7.75 | 3.97 | 15.9 | 0.49 | 1600 |
| 08-B1 | 8187 | 1/2x1/4" | | | 6.40 | 8.51 | 4.45 | 16.9 | 0.67 | 2200 |
| 08-B1 | 8187 | •1/2x5/16"+ | | | 7.75 | 8.51 | 4.45 | 18.4 | 0.72 | 2200 |
| 10-B1 | W | 5/8x3/16" | | | 4.88 | 7.75 | 3.58 | 12.0 | 0.29 | 1100 |
| 10-B1 | 8187 | 5/8x1/4" | 5/8" | 15.875 | 6.48 | 10.16 | 5.08 | 17.4 | 0.80 | 2800 |
| 10-B1 | 8187 | •5/8x3/8" | | | 9.65 | 10.16 | 5.08 | 20.6 | 0.91 | 2800 |
| 12-B1 | 8187 | •3/4x7/16" | 3/4" | 19.05 | 11.75 | 12.07 | 5.72 | 23.7 | 1.17 | 3400 |
| 16-B1 | 8187 | •1"x17mm | 1" | 25.4 | 17.02 | 15.88 | 8.27 | 36.8 | 2.63 | 7800 |
| 20-B1 | 8187 | •1 1/4x3/4" | 1 1/4" | 31.75 | 19.56 | 19.05 | 10.17 | 43.3 | 3.70 | 11000 |
| 24-B1 | 8187 | •1 1/2x1" | 1 1/2" | 38.1 | 25.4 | 25.4 | 14.63 | 58.5 | 6.90 | 19000 |
| 28-B1 | 8187 | 1 3/4x31 | 1.75 | 44.45 | 30.99 | 27.94 | 15.87 | 74.8 | 10.0 | 22000 |
| 32-B1 | 8187 | 2x31 | 2.0 | 50.8 | 30.99 | 29.21 | 17.8 | 82.9 | 10.7 | 26000 |
| 40-B1 | 8187 | 2.5X1.5 | 2.5 | 63.5 | 38.1 | 39.7 | 22.87 | 91.2 | 18.0 | 42000 |
| 48-B1 | 8187 | 3x45 | 3.0 | 76.2 | 45.75 | 48.26 | 29.22 | 113.6 | 29.5 | 60000 |

MAKARALI, PERÇİNLİ, MAFSALLI ZİNCİRLER

B.S.
UNI 2579-2580 o B.S. 228 o
NF.E 26.101 o DIN 8180-8187

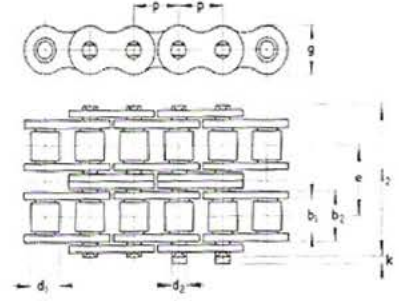

| DIN-ISO Nr. | Hatve t | | Makara Genişlik b ₁ | | Makara Kutu d ₁ | | Azami Genişlik B ₂ | | Transversal Hatve e | | Perçin Kutu d ₂ ∅ | | Sıklet | | Kopma Mukavemeti | |
|-------------------|------------|--------|-----------------------------------|-------|-------------------------------|-------|----------------------------------|--------|------------------------|-------|---------------------------------|-------|--------|--------|------------------|-----|
| | inç | mm | inç | mm | inç | mm | inç | mm | inç | mm | inç | mm | lb/ft. | Kg/mt | lb. | Kg. |
| İKİ SIRALI | | | | | | | | | | | | | | | | |
| 04-82 | .236 | 6.0 | .11 | 2.8 | .157 | 4.0 | .547 | 13.9 | .217 | 5.5 | 1.85 | .15 | .23 | 1210 | 550 | |
| 05-82 | .315 | 8.0 | .124 | 3.15 | .197 | 5.0 | .587 | 14.9 | .222 | 5.64 | 2.30 | .22 | .33 | 2090 | 950 | |
| 06-82 | 3/8" | 9.525 | .23 | 5.9 | .25 | 6.35 | .965 | 24.5 | .403 | 10.24 | 3.31 | .5 | .74 | 5300 | 2400 | |
| 08-82 | 1/2" | 12.7 | .305 | 7.75 | .335 | 8.51 | 1.27 | 32.3 | .548 | 13.92 | 4.45 | .91 | 1.36 | 8800 | 4000 | |
| 10-82 | 5/8" | 15.875 | .38 | 9.65 | .4 | 10.16 | 1.46 | 37.2 | .653 | 16.59 | 5.08 | 1.22 | 1.82 | 12320 | 5600 | |
| 12-82 | 3/4" | 19.05 | .46 | 11.75 | .475 | 12.07 | 1.705 | 43.3 | .766 | 19.46 | 5.72 | 1.59 | 2.36 | 15400 | 7000 | |
| 16-82 | 1" | 25.04 | .67 | 17.02 | .625 | 15.88 | 2.705 | 68.7 | 1.255 | 31.88 | 8.27 | 3.5 | 5.22 | 33000 | 15000 | |
| 20-82 | 1.25 | 31.75 | .77 | 19.56 | .75 | 19.05 | 3.138 | 79.7 | 1.435 | 36.45 | 10.17 | .5 | 7.4 | 48400 | 22000 | |
| 24-82 | 1.5 | 38.1 | 1.0 | 25.4 | 1.0 | 25.4 | 4.205 | 106.8 | 1.904 | 48.36 | 14.63 | .95 | 14.1 | 83600 | 38000 | |
| 28-82 | 1.75 | 44.45 | 1.22 | 30.99 | 1.1 | 27.94 | 5.29 | 134.36 | 2.345 | 59.56 | 15.87 | 13.47 | 20.00 | 84000 | 38100 | |
| 32-82 | 2.0 | 50.8 | 1.22 | 30.99 | 1.15 | 29.21 | 5.57 | 141.45 | 2.305 | 58.55 | 17.80 | 14.15 | 21.0 | 109000 | 49500 | |
| 40-82 | 2.5 | 63.5 | 1.5 | 38.1 | 1.55 | 39.37 | 6.44 | 163.49 | 2.846 | 72.29 | 22.87 | 24.25 | 36.0 | 176500 | 80000 | |
| ÜÇ SIRALI | | | | | | | | | | | | | | | | |
| 06-83 | 3/8" | 9.525 | .23 | 5.9 | .25 | 6.35 | 1.36 | 34.6 | .403 | 10.24 | 3.31 | .73 | 1.09 | 6390 | 2900 | |
| 08-83 | 1/2" | 12.7 | .305 | 7.75 | .335 | 8.51 | 1.82 | 46.2 | .548 | 13.92 | 4.45 | 1.36 | 2.02 | 12760 | 5800 | |
| 10-83 | 5/8" | 15.875 | .38 | 9.65 | .4 | 10.16 | 2.11 | 53.7 | .653 | 16.59 | 5.08 | 1.83 | 2.73 | 17600 | 8000 | |
| 12-83 | 3/4" | 19.05 | .46 | 11.75 | .475 | 12.07 | 2.46 | 62.6 | .766 | 19.46 | 5.72 | 2.38 | 3.54 | 22000 | 10000 | |
| 16-83 | 1" | 25.4 | .67 | 17.02 | .625 | 15.88 | 3.96 | 100.7 | 1.255 | 31.88 | 8.27 | 5.28 | 7.85 | 48400 | 22000 | |
| 20-83 | 1.25 | 31.75 | .77 | 19.56 | .75 | 19.05 | 4.57 | 116.1 | 1.435 | 36.45 | 10.17 | 7.46 | 11.1 | 72600 | 33000 | |
| 24-83 | 1.5 | 38.1 | 1.0 | 25.4 | 1.0 | 25.4 | 6.1 | 155.1 | 1.904 | 48.36 | 14.63 | 14.52 | 21.6 | 125400 | 57000 | |
| 28-83 | 1.75 | 44.45 | 1.22 | 30.99 | 1.1 | 27.94 | 7.63 | 193.92 | 2.345 | 59.56 | 15.87 | 20.21 | 30.0 | 126800 | 57500 | |
| 32-83 | 2.0 | 50.8 | 1.22 | 30.99 | 1.15 | 29.21 | 7.87 | 200.0 | 2.305 | 58.55 | 17.80 | 21.56 | 32.00 | 163800 | 74300 | |

MAKARALI, PERÇİNLİ, MAFSALLI ZİNCİRLER

A.S.A.
DIN 8188 ASA

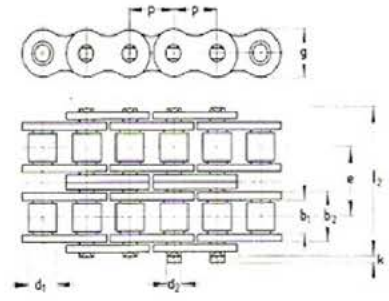

| DIN-ISO Nr. | Asa No | Havve | | İç Genişlik | | Makara Kutru | | Azami Genişlik | | Çalışma Sahası | | Sıklet | | Kopma Mukavemeti | |
|-------------------|--------|----------|--------|-------------|-------|--------------|-------|----------------|------|----------------|------|--------|-------|------------------|-------|
| | | t inç | mm | b1 inç | mm | d1 inç | mm | B2 inç | mm | e inç | mm | lb/ft. | Kg/mt | lb. | Kg. |
| TEK SIRALI | | | | | | | | | | | | | | | |
| 04A1 | 25 | 1/4 | 6.35 | .125 | 3.18 | .130 | 3.3 | .319 | 8.1 | .017 | 11 | .09 | .13 | 880 | 400 |
| 06A1 | 35 | 3/8 | 9.525 | .188 | 4.77 | .2 | 5.08 | .5 | 12.7 | .042 | 27 | .21 | .31 | 2840 | 1300 |
| — | 41 | 1/2 | 12.7 | .25 | 6.35 | .305 | 7.75 | .618 | 15.7 | .050 | 32 | .28 | .41 | 2200 | 1000 |
| 08A1 | 40 | 1/2 | 12.7 | .312 | 7.94 | .312 | 7.94 | .685 | 17.4 | .068 | 44 | .40 | .60 | 3960 | 1800 |
| 10A1 | 50 | 5/8 | 15.875 | .375 | 9.53 | .4 | 10.16 | .85 | 21.6 | .109 | 70 | .68 | 1.01 | 6160 | 2800 |
| 12A1 | 60 | 3/4 | 19.05 | .5 | 12.7 | .469 | 11.9 | 1.06 | 26.9 | .164 | 106 | 1.0 | 1.49 | 9240 | 4200 |
| 16A1 | 80 | 1- | 25.4 | .625 | 15.88 | .625 | 15.88 | 1.37 | 34.8 | .277 | 179 | 1.69 | 2.52 | 15840 | 7200 |
| 20A1 | 100 | 1 1/4 | 31.75 | .75 | 19.05 | .75 | 19.05 | 1.67 | 42.3 | .406 | 262 | 2.51 | 3.73 | 24200 | 11000 |
| 24A1 | 120 | 1 1/2 | 38.1 | 1.0 | 25.4 | .875 | 22.22 | 2.09 | 53.0 | .611 | 394 | 3.6 | 5.35 | 33900 | 15400 |
| 28A1 | 140 | 1 3/4 | 44.45 | 1.0 | 25.4 | 1.0 | 25.4 | 2.26 | 57.5 | .732 | 472 | 4.98 | 7.4 | 46300 | 21000 |
| 32A1 | 160 | 2- | 50.8 | 1.25 | 31.75 | 1.125 | 28.57 | 2.68 | 68.1 | 1.01 | 650 | 6.53 | 9.7 | 58200 | 26400 |
| 40A1 | 200 | 2 1/2 | 63.5 | 1.5 | 38.1 | 1.562 | 39.68 | 3.34 | 84.9 | 1.69 | 1090 | 11.45 | 17.0 | 94800 | 43000 |

| Nr. | Asa No | t | | b1 | | d1 | | B2 | | e | | Çalışma Sahası | | Sıklet | | Kopma Mukavemeti | |
|-------------------|--------|--------|--------|------|-------|-------|-------|-------|--------|-------|-------|----------------|------|--------|-------|------------------|-------|
| | | inç | mm | inç | mm | inç | mm | inç | mm | inç | mm | inç | mm | lb/ft. | Kg/mt | lb. | Kg. |
| İKİ SIRALI | | | | | | | | | | | | | | | | | |
| 04-A2 | 25-2 | 1/4" | 6.35 | .125 | 3.18 | .13 | 3.3 | .571 | 14.5 | .252 | 6.4 | .034 | 22 | .17 | .26 | 1600 | 720 |
| 06-A2 | 35-2 | 3/8" | 9.525 | .188 | 4.77 | .2 | 5.08 | .897 | 22.8 | .399 | 10.13 | .084 | 54 | .45 | .67 | 5300 | 2400 |
| 08-A2 | 40-2 | 1/2" | 12.7 | .312 | 7.94 | .312 | 7.94 | 1.25 | 31.8 | .566 | 14.38 | .136 | 88 | .81 | 1.19 | 7900 | 3600 |
| 10-A2 | 50-2 | 5/8" | 15.875 | .375 | 9.53 | .4 | 10.16 | 1.562 | 39.7 | .713 | 18.11 | .217 | 110 | 1.29 | 1.92 | 12300 | 5600 |
| 12-A2 | 60-2 | 3/4" | 19.05 | .5 | 12.7 | .469 | 11.9 | 1.955 | 49.7 | .897 | 22.78 | .329 | 212 | 2.06 | 3.07 | 20250 | 9200 |
| 16-A2 | 80-2 | 1" | 25.4 | .625 | 15.88 | .625 | 15.88 | 2.52 | 64.1 | 1.153 | 29.29 | .555 | 358 | 3.39 | 5.05 | 31900 | 14500 |
| 20-A2 | 100-2 | 1 1/4" | 31.75 | .75 | 19.05 | .75 | 19.05 | 3.07 | 78.0 | 1.408 | 35.76 | .812 | 524 | 4.91 | 7.31 | 48400 | 22000 |
| 24-A2 | 120-2 | 1 1/2" | 38.1 | 1.0 | 25.4 | .875 | 22.22 | 3.87 | 98.4 | 1.789 | 45.44 | 1.22 | 788 | 7.19 | 10.7 | 68200 | 31000 |
| 28-A2 | 140-2 | 1 3/4" | 44.45 | 1.0 | 25.4 | 1.0 | 25.4 | 4.188 | 106.37 | 1.924 | 48.87 | 1.46 | 944 | 9.9 | 14.7 | 92600 | 42000 |
| 32-A2 | 160-2 | 2" | 50.8 | 1.25 | 31.75 | 1.125 | 28.57 | 4.986 | 126.65 | 2.305 | 58.55 | 2.02 | 1300 | 12.87 | 19.1 | 11640 | 52800 |
| 40-A2 | 200-2 | 2.5" | 63.5 | 1.5 | 38.1 | 1.562 | 39.68 | 6.159 | 156.45 | 2.817 | 71.55 | 3.38 | 2180 | 22.63 | 33.6 | 189600 | 86000 |
| ÜÇ SIRALI | | | | | | | | | | | | | | | | | |
| 04-A3 | 25-3 | 1/4" | 6.35 | .125 | 3.18 | .13 | 3.3 | .822 | 20.9 | .252 | 6.4 | .051 | 33 | .26 | .39 | 2452 | 1100 |
| 06-A3 | 35-3 | 3/8" | 9.525 | .188 | 4.77 | .2 | 5.08 | 1.3 | 33.0 | .399 | 10.13 | .126 | 81 | .679 | 1.01 | 8150 | 3700 |
| 08-A3 | 40-3 | 1/2" | 12.7 | .312 | 7.94 | .312 | 7.94 | 1.82 | 46.2 | .566 | 14.38 | .205 | 132 | 1.31 | 1.95 | 11450 | 5200 |
| 10-A3 | 50-3 | 5/8" | 15.875 | .375 | 9.53 | .4 | 10.16 | 2.28 | 57.8 | .713 | 18.11 | .326 | 210 | 1.94 | 2.89 | 17600 | 8000 |
| 12-A3 | 60-3 | 3/4" | 19.05 | .5 | 12.7 | .469 | 11.9 | 2.85 | 72.4 | .897 | 22.78 | .493 | 318 | 3.125 | 4.65 | 29700 | 13500 |
| 16-A3 | 80-3 | 1" | 25.4 | .625 | 15.88 | .625 | 15.88 | 3.68 | 93.4 | 1.153 | 29.29 | .832 | 537 | 5.087 | 7.57 | 46200 | 21000 |
| 20-A3 | 100-3 | 1 1/4" | 31.75 | .75 | 19.05 | .75 | 19.05 | 4.48 | 113.8 | 1.408 | 35.76 | 1.218 | 786 | 7.399 | 11.01 | 72600 | 33000 |
| 24-A3 | 120-3 | 1 1/2" | 38.1 | 1.0 | 25.4 | .875 | 22.22 | 5.66 | 143.9 | 1.789 | 45.44 | 1.832 | 1182 | 10.819 | 16.1 | 92400 | 42000 |
| 28-A3 | 140-3 | 1 3/4" | 44.45 | 1.0 | 25.4 | 1.0 | 25.4 | 6.112 | 155.24 | 1.924 | 48.87 | 2.2 | 1416 | 14.68 | 21.8 | 139000 | 63000 |
| 32-A3 | 160-3 | 2" | 50.8 | 1.25 | 31.75 | 1.125 | 28.57 | 7.291 | 185.2 | 2.305 | 58.55 | 3.02 | 1950 | 19.4 | 28.8 | 174200 | 79000 |

NORM HARİCİ - TEK SIRALI HUSUSİ ZİNCİRLER

| Nr. | t | | b ₁ mm | b ₂ mm | d ₁ Ø mm | d ₂ Ø mm | f ₁ mm | f ₂ mm | g mm | Çalışma Sahası cm ² | Kopma Mukavemeti Kg. | Siklet Kg/mt | | |
|---------|--------|----------|----------------------|----------------------|---------------------------|---------------------------|----------------------|----------------------|---------|--------------------------------------|----------------------------|-----------------|------|------|
| | mm | inç | | | | | | | | | | | | |
| •00132 | 12.7 | 1/2x5/16 | 8.0 | 10.7 | 7.75 | 3.58 | 9.1 | 7.8 | 10 | 0.37 | 1000 | 0.45 | | |
| 18 | 12.7 | 1/2x3/16 | 4.88 | 9.3 | 7.75 | 4.18 | 8.2 | 7.2 | 11.6 | 0.39 | 1800 | 0.55 | | |
| 00463 | 12.7 | 1/2 | 9.53 | 13.5 | 8.51 | 4.45 | 11.0 | 10.0 | 12.0 | 0.56 | 2200 | 0.80 | | |
| 00810 | 15 | - | 6.0 | 10.5 | 9.0 | 4.67 | 12.0 | 10.5 | 11.2 | 0.49 | 1900 | 0.62 | | |
| 00815 | 15 | - | 10.0 | 14.3 | 9.0 | 4.67 | 13.7 | 12.3 | 11.2 | 0.65 | 1900 | 0.74 | | |
| •00130 | 15.875 | 5/8x1/4 | 6.4 | 9.0 | 7.75 | 3.58 | 7.9 | 6.7 | 10.5 | 0.30 | 1000 | 0.36 | | |
| 00471 | 15.875 | 5/6 | 8.0 | 10.3 | 8.51 | 4.45 | 9.3 | 8.1 | 11.8 | 0.43 | 2000 | 0.63 | | |
| 00472 | | | 7.8 | 11.3 | 8.51 | 4.45 | 10.0 | 9.0 | 11.8 | 0.50 | 2000 | 0.67 | | |
| 00502 | | | 13.0 | 17.2 | 10.16 | 5.08 | 12.9 | 12.0 | 14.5 | 0.86 | 2800 | 1.12 | | |
| 00510 | | | 6.4 | 10.3 | 10.16 | 5.08 | 10.4 | 8.6 | 12.0 | 0.53 | 2400 | 0.68 | | |
| 00511 | 19.05 | 3/4 | 9.65 | 13.3 | 10.16 | 5.08 | 12.0 | 10.0 | 12.0 | 0.69 | 2400 | 0.78 | | |
| 00512 | | | 8.0 | 13.4 | 12.07 | 6.00 | 12.0 | 10.4 | 16.0 | 0.80 | 32000 | 1.18 | | |
| 00512 b | | | 8.0 | 12.3 | 11.0 | 6.00 | 11.0 | 10.0 | 15.0 | 0.74 | 2500 | 0.90 | | |
| 00480 | | | 11.68 | 17.1 | 12.07 | 6.00 | 15.1 | 14.1 | 15.0 | 1.02 | 3800 | 1.33 | | |
| 00513 b | | | 12.7 | 19.0 | 12.07 | 6.00 | 15.1 | 14.3 | 16.0 | 1.14 | 4000 | 1.56 | | |
| 19122 v | | | 12.7 | 19.0 | 12.1 | 6.00 | 16.2 | 14.3 | 17.0 | 1.14 | 4200 | 1.80 | | |
| 19132 | | | 13.5 | 19.5 | 12.07 | 5.72 | 16.0 | 15.0 | 16.5 | 1.11 | 3300 | 1.60 | | |
| 00514 | | | 15.5 | 20.8 | 12.07 | 6.00 | 15.7 | 14.0 | 16.0 | 1.25 | 3200 | 1.53 | | |
| 00820 | | | 20 | - | 12.0 | 16.5 | 9.5 | 5.00 | 14.5 | 12.5 | 15.5 | 0.80 | 3000 | 0.96 |
| 00520 | | | 22.2 | 7/8 | 11.2 | 16.5 | 12.07 | 6.00 | 17.2 | 13.2 | 14.4 | 1.00 | 2200 | 1.10 |
| 00540 | 25.4 | 1 | 12.7 | 18.0 | 12.7 | 6.50 | 21.0 | 14.5 | 18.3 | 1.17 | 3500 | 1.36 | | |
| 00540 e | | | 12.7 | 18.0 | 12.0 | 6.50 | 21.0 | 14.5 | 18.3 | 1.17 | 3500 | 1.36 | | |
| 00541 | | | 9.5 | 15.8 | 14.0 | 7.00 | 19.0 | 13.7 | 18.3 | 1.10 | 2800 | 1.49 | | |
| 00546 | | | 12.7 | 19.0 | 14.0 | 7.00 | 21.0 | 15.7 | 18.3 | 1.33 | 2800 | 1.64 | | |
| 00546 b | | | 12.7 | 20.0 | 14.0 | 7.00 | 16.7 | 15.0 | 18.3 | 1.40 | 6700 | 2.30 | | |
| 00547 | | | 12.7 | 21.5 | 15.88 | 8.27 | 24.0 | 19.0 | 24.0 | 1.79 | 6500 | 2.70 | | |
| 00547 b | | | 12.7 | 23.2 | 15.88 | 8.27 | 22.5 | 20.0 | 24.0 | 1.92 | 6500 | 3.35 | | |
| 00548 b | | | 17.0 | 27.2 | 15.88 | 8.27 | 28.0 | 23.0 | 24.0 | 2.25 | 6500 | 3.55 | | |
| 25129 | | | 12.0 | 16.5 | 9.5 | 5.03 | 14.5 | 12.2 | 14.4 | 0.83 | 2500 | 0.85 | | |
| 25122 | | | 12.7 | 18.9 | 12.7 | 6.98 | 16.5 | 14.5 | 18.5 | 1.32 | 3000 | 1.55 | | |
| 25194 | 19.0 | 25.5 | 14.0 | 6.88 | 20.9 | 17.9 | 23.4 | 1.75 | 3000 | 2.50 | | | | |
| 00585 L | 12.7 | 19.7 | 14.0 | 7.5 | 17.3 | 15.3 | 23.0 | 1.47 | 6500 | 2.30 | | | | |
| 00550 | 30 | - | 12.7 | 19.3 | 12.7 | 6.50 | 20 | 15 | 21 | 1.23 | 4350 | 1.40 | | |
| 00551 | | | 12.7 | 21.5 | 15.88 | 8.27 | 24 | 19 | 24 | 1.79 | 6500 | 2.50 | | |
| 00553 | | | 20.1 | 28.8 | 15.88 | 8.27 | 28 | 23 | 24 | 2.38 | 6500 | 2.85 | | |
| 30194 | | | 19.0 | 25.5 | 14.0 | 6.88 | 20.9 | 17.9 | 23.4 | 1.75 | 3000 | 2.20 | | |
| 00552 | | | 17.02 | 25.45 | 15.88 | 8.27 | 24.5 | 18.0 | 24 | 2.1 | 7500 | 2.70 | | |
| 00561 | | | 17.1 | 23.2 | 15.88 | 8.27 | 24 | 18 | 24 | 2.00 | 6500 | 2.30 | | |
| 00562 | 31.75 | 11/4 | 14.0 | 24.0 | 19.05 | 10.17 | 24 | 21 | 26 | 2.40 | 8500 | 3.44 | | |
| 00570 | 35 | - | 16.0 | 22.0 | 15.5 | 8.27 | 22 | 16 | 24 | 1.80 | 6500 | 1.95 | | |
| 00575 | | | 18.0 | 25.5 | 18.0 | 10.17 | 25 | 19 | 26 | 2.54 | 8500 | 2.75 | | |
| 00577 | | | 19.6 | 27.0 | 19.05 | 10.17 | 26 | 20 | 26 | 2.70 | 8500 | 3.05 | | |
| 00593 | | | 15.9 | 25.5 | 21.6 | 12.00 | 27 | 21 | 33 | 3.00 | 11500 | 4.00 | | |
| 00594 | 22.1 | 31.6 | 21.6 | 12.00 | 32 | 24 | 33 | 3.72 | 11500 | 4.50 | | | | |
| 00595 | 19.1 | 31.6 | 25.4 | 14.63 | 32 | 26 | 37 | 4.55 | 12000 | 6.87 | | | | |
| •38131 | 38.1 | 11/2 | 13.1 | 19.5 | 11.9 | 5.98 | 17.2 | 14.6 | 16.0 | 1.17 | 3000 | 1.33 | | |
| •38192 | | | 19.1 | 24.6 | 12.1 | 5.98 | 20.0 | 17.0 | 16.0 | 1.47 | 3000 | 1.36 | | |
| 38225 | | | 22.2 | 28.6 | 15.24 | 5.74 | 21.6 | 19.05 | 17.3 | 1.64 | 1810 | 1.56 | | |
| •38195 | 38.4 | - | 19.1 | 24.6 | 15.9 | 6.92 | 20.0 | 17.0 | 16.0 | 1.47 | 2000 | 1.63 | | |
| •38225 | | | 22.0 | 27.45 | 15.9 | 5.98 | 21.4 | 18.4 | 16.0 | 1.64 | 200 | 1.80 | | |

NORM HARİCİ - TEK SIRALI HUSUSİ ZİNCİRLER

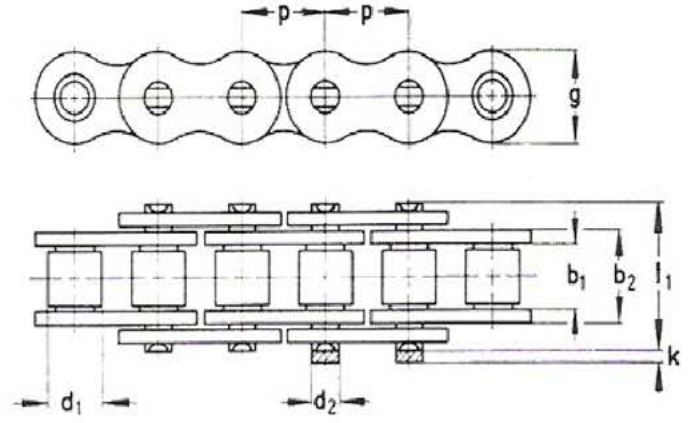

| Nr. | † | | b ₁ mm | b ₂ mm | d ₁ mm | d ₂ mm | f ₁ mm | f ₂ mm | g mm | Çalışma Sahası cm ² | Kopma Mukavemeti Kg. | Siklet Kg/mt |
|-----------|-------|--------------|----------------------|----------------------|----------------------|----------------------|----------------------|----------------------|---------|--------------------------------------|----------------------------|-----------------|
| | mm | Hatve inç | | | | | | | | | | |
| • 38195 | 38.4 | - | 19.1 | 24.6 | 15.9 | 6.92 | 20.0 | 17.0 | 16.0 | 1.47 | 2000 | 1.63 |
| • 38225 | 40 | - | 22.0 | 27.45 | 15.9 | 5.98 | 21.4 | 18.4 | 16.0 | 1.64 | 2000 | 1.80 |
| 00602 | | - | 20.1 | 28.5 | 21.6 | 12.00 | 29 | 21 | 31 | 3.37 | 12000 | 3.60 |
| 00603 | 40 | - | 25.0 | 32.5 | 19.05 | 10.117 | 29 | 23 | 27 | 3.25 | 8500 | 3.07 |
| • 40222 | | - | 22.0 | 27.45 | 12.1 | 5.98 | 21.4 | 18.4 | 16.0 | 1.64 | 2000 | 1.46 |
| 40194 | 40.6 | - | 19.0 | 24.4 | 14.0 | 7.98 | 20.8 | 16.8 | 19.0 | 1.95 | 3000 | 1.41 |
| • 41256 | 41.3 | - | 25.5 | 31.5 | 16.0 | 8.98 | 23.9 | 21.4 | 26.0 | 2.83 | 5000 | 2.85 |
| 41227 | 41.4 | - | 22.0 | 27.45 | 17.8 | 5.98 | 21.4 | 18.4 | 19.0 | 1.64 | 2000 | 1.20 |
| 41215 | | | 22.0 | 27.45 | 15.9 | 5.98 | 21.4 | 18.4 | 19.0 | 1.64 | 2000 | 1.15 |
| • 41205 | 41.5 | - | 20.7 | 27.2 | 15.9 | 9.05 | 22.3 | 19.3 | 26.0 | 2.44 | 5000 | 2.80 |
| 41278 | 41.73 | - | 27.5 | 34.95 | 18.0 | 7.98 | 26.8 | 23.0 | 22.0 | 2.79 | 3500 | 2.48 |
| • 41259 | 41.91 | - | 25.4 | 31.8 | 19.05 | 5.74 | 22.9 | 20.3 | 17.3 | 1.82 | 2730 | 1.87 |
| 00608 | | | 13.0 | 20.0 | 19.05 | 10.17 | 19.0 | 16.0 | 28.0 | 2.00 | 8500 | 2.50 |
| 00611 | | | 25.4 | 37.9 | 25.4 | 14.63 | 37.2 | 26.6 | 41 | 5.54 | 12000 | 6.60 |
| 00612 | 44.45 | 13/14 | 22.2 | 38.6 | 27.94 | 15.85 | 39 | 32 | 41 | 6.05 | 14000 | 9.20 |
| 00614 | | | 30.0 | 42.5 | 22.2 | 12.00 | 39 | 29 | 32 | 5.05 | 12000 | 5.85 |
| 00651 H | 50.8 | 2 | 22.2 | 38.8 | 29.21 | 17.85 | 41 | 32 | 44 | 6.80 | 26000 | 9.65 |
| 00660 H | 57.2 | 2 1/4 | 25.4 | 43.0 | 34.3 | 20.30 | 49 | 38 | 50 | 9.05 | 36000 | 13.30 |
| 00661 H | | | 34.3 | 52.0 | 34.3 | 20.30 | 52 | 42 | 50 | 10.80 | 36000 | 15.00 |
| • 00679 b | 76.2 | 3 | 45.8 | 76.8 | 48.26 | 29.22 | 54.5 | 53.5 | 70 | 22.2 | 75000 | 29.50 |

UZUN BAKLALI, MAKARALI ZİNCİRLER

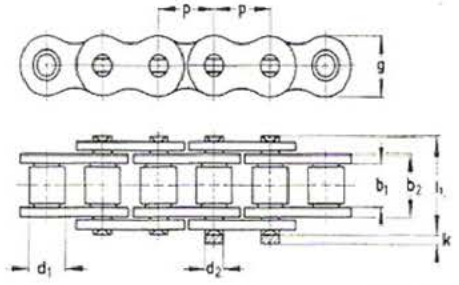

B.S. / DIN 8181

| Nr. | Hatve t | | Makara Genişlik b ₁ | | Makara Kutru d ₁ | | Azami Genişlik B ₂ | | Çalışma Sahası | | Siklet | | Kopma Mukavemeti | |
|-----------------------------------|------------|-------|-----------------------------------|-------|--------------------------------|-------|----------------------------------|------|------------------|-----------------|--------|-------|------------------|-------|
| | inç | mm | inç | mm | inç | mm | inç | mm | inç ² | mm ² | lb/ft. | Kg/mt | lb. | Kg. |
| B.S. / RIH 8181 TEK SIRALI | | | | | | | | | | | | | | |
| LR 165 | 1.0 | 25.4 | .305 | 7.75 | .335 | 8.51 | .728 | 18.5 | .078 | 50 | .349 | .52 | 4840 | 2200 |
| LR 206 | 1.25 | 31.75 | .38 | 9.65 | .4 | 10.16 | .815 | 20.7 | .104 | 67 | .423 | .63 | 6160 | 2800 |
| LR 247 | 1.5 | 38.1 | .46 | 11.75 | .475 | 12.07 | .945 | 24.0 | .138 | 89 | .571 | .85 | 7480 | 3400 |
| LR 3211 | 2.0 | 50.8 | .67 | 17.02 | .625 | 15.88 | 1.496 | 38.0 | .326 | 210 | 1.41 | 2.1 | 16500 | 7500 |
| LR 4012 | 2.5 | 63.5 | .77 | 19.56 | .75 | 19.05 | 1.894 | 48.1 | .457 | 295 | 1.75 | 2.6 | 21600 | 9800 |
| LR 4816 | 3.0 | 76.2 | 1.0 | 25.4 | 1.0 | 25.4 | 2.512 | 63.8 | .859 | 554 | 3.04 | 4.51 | 39100 | 18000 |

A.S.A. / DIN 8188

| Nr. | Asa No | Hatve t | | Makara Genişlik b ₁ | | Makara Kutru d ₁ | | Azami Genişlik B ₂ | | Çalışma Sahası | | Siklet | | Kopma Mukavemeti | |
|-------------------------------------|--------|------------|-------|-----------------------------------|-------|--------------------------------|-------|----------------------------------|------|------------------|-----------------|--------|-------|------------------|------|
| | | inç | mm | inç | mm | inç | mm | inç | mm | inç ² | mm ² | lb/ft. | Kg/mt | lb. | Kg. |
| A.S.A. / DIN 8188 TEK SIRALI | | | | | | | | | | | | | | | |
| LR 165A | 2040 | 1.0 | 25.4 | .312 | 7.94 | .312 | 7.94 | .677 | 17.2 | .068 | 44 | .33 | .49 | 3650 | 1650 |
| LR 206A | 2050 | 1.25 | 31.75 | .375 | 9.53 | .4 | 10.16 | .85 | 21.6 | .109 | 70 | .44 | .65 | 6200 | 2800 |
| LR 248A | 2060 | 1.5 | 38.1 | .5 | 12.7 | .469 | 11.9 | 1.059 | 26.9 | .164 | 106 | .64 | .95 | 8600 | 3900 |
| LR 3210A | 2080 | 2.0 | 50.8 | .025 | 15.88 | .625 | 15.88 | 1.37 | 34.8 | .277 | 179 | 1.3 | 1.93 | 14550 | 6600 |

Parmak Kesirleri

| | | | | |
|------------------|-------------------|-------------------|-------------------|--------------------|
| 1/64 = 0.397 m/m | 11/16 = 4.366 m/m | 21/64 = 8.334 m/m | 9/16 = 14.288 m/m | 27/32 = 21.431 m/m |
| 1/32 = 0.794 | 3/16 = 4.763 | 11/32 = 8.371 | 19/32 = 15.081 | 7/8 = 22.225 |
| 3/64 = 0.1.191 | 13/64 = 5.159 | 23/64 = 9.128 | 5/8 = 15.875 | 29/32 = 23.019 |
| 1/16 = 1.588 | 7/32 = 5.556 | 3/8 = 9.525 | 21/32 = 16.669 | 15/16 = 23.812 |
| 5/64 = 1.984 | 15/64 = 5.953 | 13/32 = 10.319 | 11/16 = 17.462 | 31/32 = 24.606 |
| 3/32 = 2.281 | 1/4 = 6.350 | 27/64 = 10.716 | 23/32 = 18.256 | 1. = 25.400 |
| 7/64 = 2.778 | 17/64 = 6.747 | 7/16 = 11.113 | 3/4 = 19.050 | 1.1/4 = 31.75 |
| 1/8 = 3.175 | 9/32 = 7.144 | 15/32 = 11.906 | 25/32 = 19.844 | 1.1/2 = 38.1 |
| 9/64 = 3.572 | 19/64 = 7.541 | 1/2 = 12.700 | 51/64 = 20.241 | 1.3/4 = 44.45 |
| 5/32 = 3.969 | 5/16 = 7.938 | 17/32 = 13.494 | 13/16 = 20.637 | |

MAKARASIZ ZINCIRLER (HÜLSEN)

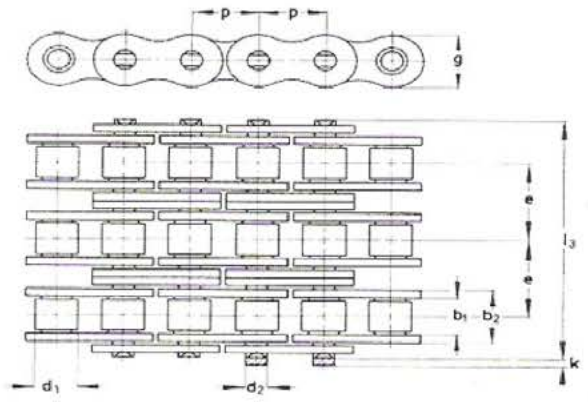

DIN 73232 VE A5A/DIN 8188

| Nr. | Hatve | | İç Genişlik | | Makara Kutru | | Genişlik | | Transversal Hatve | | Çalışma Sahası | | Siklet | | Kopma Mukavemeti | |
|-------------------|-------|-------|-------------|------|--------------|------|----------|------|-------------------|-------|------------------|-----------------|--------|-------|------------------|------|
| | inç | mm | inç | mm | inç | mm | inç | mm | inç | mm | inç ² | mm ² | lb/ft. | Kg/mt | lb. | Kg. |
| TEK SIRALI | | | | | | | | | | | | | | | | |
| G 63 H 5 | .375 | 9.525 | .181 | 4.60 | .197 | 5.0 | .532 | 13.5 | | | .042 | 27 | .255 | .38 | 2860 | 1300 |
| G 65 H 5 | .375 | 9.525 | .295 | 7.50 | .197 | 5.0 | .65 | 16.5 | | | .059 | 38 | .275 | .41 | 2750 | 1250 |
| G 66 H 6 | .375 | 9.525 | .375 | 9.52 | .236 | 6.0 | .764 | 19.4 | | | 0.91 | 59 | .423 | .63 | 3080 | 1400 |
| G 63 HA | .375 | 9.525 | .188 | 4.77 | .2 | 5.08 | .5 | 12.7 | | | .042 | 27 | .21 | .31 | 2860 | 1300 |
| İKİ SIRALI | | | | | | | | | | | | | | | | |
| D 63 H 5 | .375 | 9.525 | .181 | 4.60 | .197 | 5.0 | .917 | 23.3 | .386 | 9.8 | .085 | 55 | .47 | .70 | 5280 | 2400 |
| D 63 HA | .375 | 9.525 | .188 | 4.77 | .2 | 5.08 | .898 | 22.8 | .399 | 10.13 | .084 | 54 | .45 | .67 | 5280 | 2400 |
| ÜÇ SIRALI | | | | | | | | | | | | | | | | |
| Tr 63 H 5 | .375 | 9.525 | .181 | 4.60 | .197 | 5.0 | 1.331 | 33.8 | .4 | 10.15 | .129 | 83 | .719 | 1.07 | 8140 | 3700 |
| Tr 63 HA | .375 | 9.525 | .188 | 4.77 | .2 | 5.08 | 1.229 | 33.0 | .399 | 10.13 | .126 | 81 | .679 | 1.01 | 8140 | 3700 |

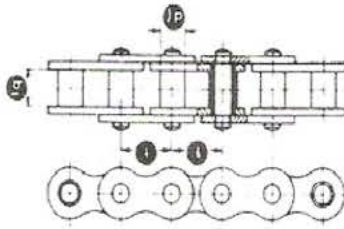

SABİT BURÇLU ZİNCİRLER

DIN 8164

| Nr. | Hatve | | İç Genişlik | | Pim Kutru | | Azami Genişlik | | Çalışma Sahası | | Siklet | | Kopma Mukavemeti | |
|-------|-------|----|-------------|----|-----------|----|----------------|-----|------------------|-----------------|--------|-------|------------------|-------|
| | inç | mm | inç | mm | inç | mm | inç | mm | inç ² | mm ² | lb/ft. | Kg/mt | lb. | Kg. |
| 00200 | .59 | 15 | .551 | 14 | .354 | 9 | 1.260 | 32 | .172 | 111 | .692 | 1.03 | 4840 | 2000 |
| 00203 | .787 | 20 | .630 | 16 | .472 | 12 | 1.496 | 38 | .285 | 184 | 1.357 | 2.02 | 8360 | 3800 |
| 00206 | .984 | 25 | .709 | 18 | .59 | 15 | 1.693 | 43 | .388 | 250 | 1.747 | 2.60 | 11000 | 5000 |
| 00209 | 1.181 | 30 | .787 | 20 | .669 | 17 | 1.929 | 49 | .494 | 319 | 2.251 | 3.35 | 14300 | 6500 |
| 00212 | 1.378 | 35 | .866 | 22 | .709 | 18 | 2.126 | 54 | .577 | 372 | 2.419 | 3.60 | 17600 | 8000 |
| 00215 | 1.575 | 40 | .984 | 25 | .787 | 20 | 2.402 | 61 | 0.781 | 504 | 3.797 | 5.65 | 22000 | 10000 |
| 00218 | 1.772 | 45 | 1.181 | 30 | .866 | 22 | 2.756 | 70 | 1.066 | 688 | 5.006 | 7.47 | 28600 | 13000 |
| 00221 | 1.969 | 50 | 1.378 | 35 | 1.024 | 26 | 3.11 | 79 | 1.339 | 864 | 6.518 | 9.70 | 35200 | 16000 |
| 00222 | 2.165 | 55 | 1.772 | 45 | 1.181 | 30 | 3.898 | 99 | 1.953 | 1260 | 8.602 | 12.80 | 44000 | 20000 |
| 00223 | 2.362 | 60 | 1.969 | 50 | 1.26 | 32 | 4.095 | 104 | 2.319 | 1496 | 9.946 | 14.80 | 57200 | 26000 |
| 00224 | 2.559 | 65 | 2.165 | 55 | 1.417 | 36 | 4.449 | 113 | 2.942 | 1898 | 14.986 | 22.30 | 70400 | 32000 |
| 00225 | 2.756 | 70 | 2.559 | 65 | 1.575 | 40 | 5.158 | 131 | 4.045 | 2610 | 16.598 | 24.70 | 88000 | 40000 |

ROTARY - API ZİNCİRLERİ

DIN O 8182 - DIN O 8188 / ASA
VE FABRİKA NORMU

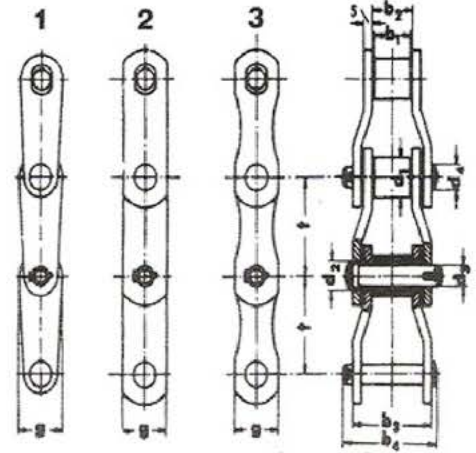

PLAKA ÇEŞİTLERİ

| Nr. | Standart | Hatve | | İç Genişlik | | Makara Kutru | | Azami Genişlik | | Kopma Mukavemeti | |
|----------|--------------|----------|-------|-----------------------|-------|-----------------------|-------|-----------------------|-------|------------------|--------|
| | | t inç | mm | b ₁ inç | mm | d ₁ inç | mm | b ₄ inç | mm | lb. | Kg. |
| 3140 | DIN 8188/ASA | 44.45 | 1.75 | 25.4 | 1.0 | 25.4 | 1.0 | 63.0 | 2.48 | 21000 | 46200 |
| 3150 | DIN 8188/ASA | 50.8 | 2.0 | 31.75 | 1.25 | 28.57 | 1.125 | 73.0 | 2.87 | 26000 | 57200 |
| 3160 | DIN 8188/ASA | 50.8 | 2.0 | 31.75 | 1.25 | 28.57 | 1.125 | 68.1 | 2.68 | 26000 | 57200 |
| 2065 | W | 50.8 | 2.0 | 31.75 | 1.25 | 28.57 | 1.125 | 80.0 | 3.15 | 33000 | 72500 |
| 3180 | W | 63.5 | 2.5 | 38.1 | 1.5 | 31.75 | 1.25 | 85.0 | 3.35 | 31750 | 70000 |
| 3200 | DIN 8188/ASA | 63.5 | 2.5 | 38.1 | 1.5 | 39.68 | 1.56 | 93.0 | 3.66 | 43000 | 95000 |
| 3300 | W | 66.27 | 2.609 | 28.57 | 1.125 | 22.23 | .875 | 66.0 | 2.60 | 11000 | 24200 |
| 3522 | W | 67.056 | 2.639 | 27.0 | 1.06 | 28.57 | 1.125 | 65.0 | 2.56 | 18000 | 39600 |
| R 2 P | A.P.I. | 77.9 | 3.067 | 38.7 | 1.52 | 41.28 | 1.625 | 97.5 | 3.84 | 45300 | 99660 |
| •R 3 | DIN 8182 | 78.105 | 3.075 | 38.1 | 1.5 | 31.75 | 1.25 | 90.0 | 3.15 | 32000 | 70000 |
| R 3 P | A.P.I. | 78.105 | 3.075 | 38.1 | 1.5 | 31.75 | 1.25 | 100.0 | 3.94 | 34000 | 75000 |
| •R 31/8 | DIN 8182 | 79.375 | 3.125 | 40.48 | 1.59 | 41.275 | 1.625 | 112.0 | 4.41 | 50000 | 110000 |
| R 31/8 W | DIN 8182 | 79.375 | 3.125 | 41.28 | 1.625 | 41.28 | 1.625 | 112.0 | 4.41 | 50000 | 11000 |
| R 31/2 | W | 88.898 | 3.5 | 38.1 | 1.5 | 44.45 | 1.75 | 98.0 | 3.86 | 63560 | 139830 |
| R 31/2 A | W | 88.898 | 3.5 | 38.1 | 1.5 | 44.45 | 1.75 | 107.0 | 4.21 | 55400 | 122880 |
| R 4 | API/DIN 8182 | 103.2 | 4.063 | 49.2 | 1.937 | 44.45 | 1.75 | 137.0 | 5.39 | 68000 | 150000 |
| R 4 P | W | 103.2 | 4.063 | 49.2 | 1.937 | 44.45 | 1.75 | 138.0 | 5.43 | 77000 | 170000 |
| R 4 PH | API 4 H | 103.45 | 4.073 | 49.0 | 1.929 | 45.25 | 1.78 | 130.0 | 5.12 | 77000 | 170000 |
| Ro 41/2 | ASA 3618 | 114.3 | 4.5 | 52.4 | 2.062 | 57.15 | 2.25 | 134.0 | 5.275 | 100000 | 220458 |
| R 5 | W | 127.0 | 5.0 | 69.85 | 2.75 | 63.5 | 2.5 | 168.0 | 6.61 | 109000 | 240000 |
| R 5 A | W | 127.0 | 5.0 | 69.85 | 2.75 | 64.0 | 2.52 | 164.0 | 6.46 | 125000 | 275000 |
| R 6 | W | 152.4 | 6.0 | 76.2 | 3.0 | 76.2 | 3.0 | 183.0 | 7.20 | 190680 | 419500 |

HAVAİ HAT SİSTEMİ

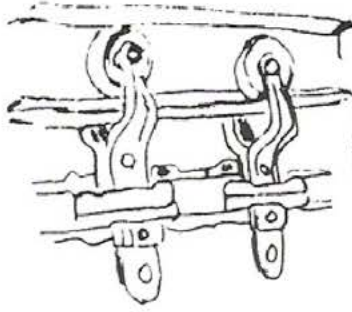

I demirde
zincirli askı arabası

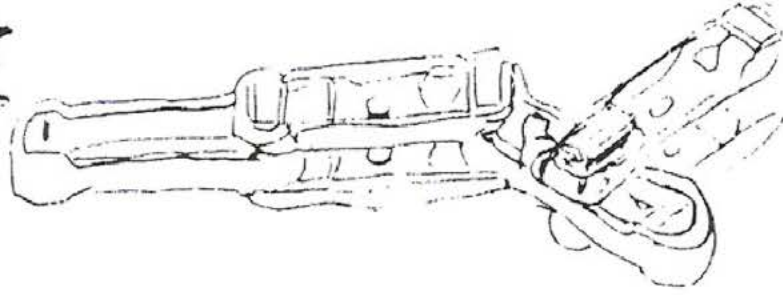

Sifero dökümden havaî hat zinciri 3" ve 4"
Kopma Mukavemeti : 3500 - 6200 kg.
Azami irtifa : 1.50 mt.

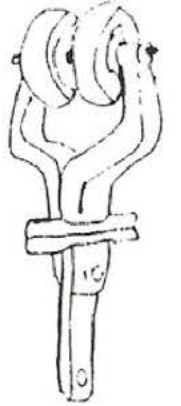

Rulmanlı trolley
(askı arabası)

KULAKLI ZİNCİR ÇEŞİTLERİ

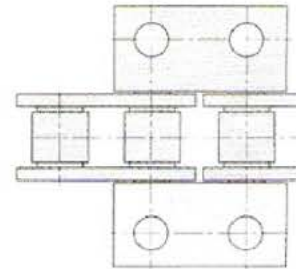
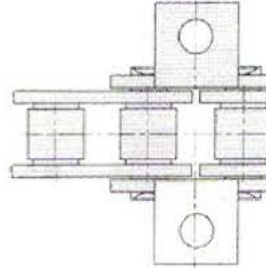
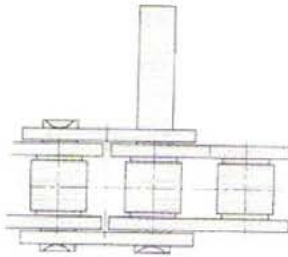
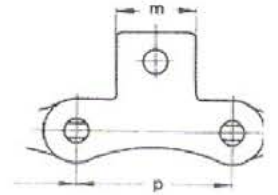
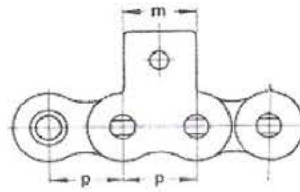
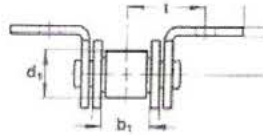
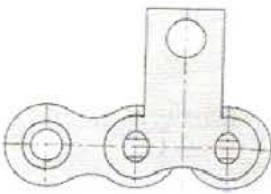

KİLİT VE YARIM BAKLA KİLİTLERİ

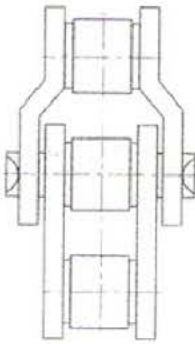

2"li 1/2
bakla

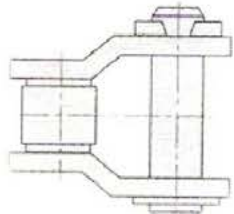

1/2 bakla

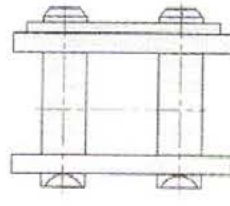

kilit

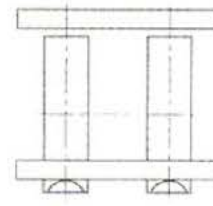

perçin

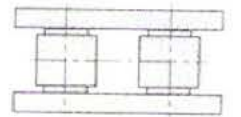

iç bakla

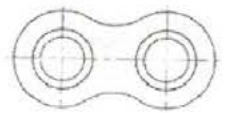
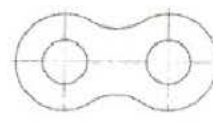
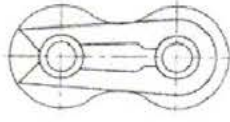
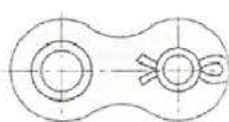

VARYATÖR ZİNCİRLERİ

PIV

A-SİSTEMİ - LAMELLİ : AKO - A1 - A2 - A3

A4 - A5 - A6 Tipleri

R-SİSTEMİ - RULMANLI : Rb0 - Rb1 - Rb2 - Rb3

Rb4 - Rc3 - Rc4 Tipleri

RS SİSTEMİ

HALKA RULMANLI

WD-SİSTEMİ: Özel salgılı pimli

A
Tipi

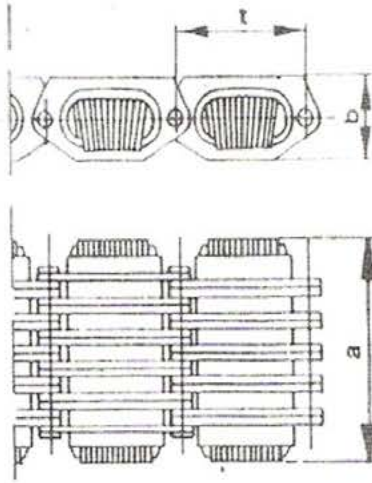

SİSTEM A LAMELLİ

| | A1 | A2 | A3 | A4 | A5 | A6 |
|-------------------------|------|------|------|------|------|------|
| HATVE (t) | 19.0 | 24.9 | 28.6 | 35.8 | 35.8 | 44.4 |
| YÜKSEKLİK (b) | 10 | 13.5 | 15.9 | 20.6 | 20.6 | 23.8 |
| GENİŞLİK (a)Yeni | 31 | 37.8 | 44.4 | 58.4 | 70 | 77.2 |
| GENİŞLİK (a)Kullanılmış | 28.6 | 35 | 40.6 | 54.5 | 65.2 | 72 |

RB
RC
Tipi

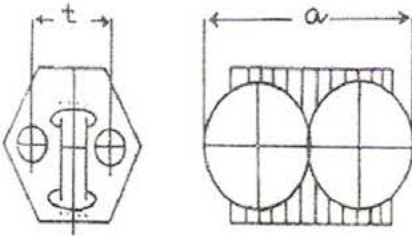

SİSTEM R RULMANLI

| | Rb0 | Rb1 | Rb2 | Rb3 | Rb4 | Rc3 | Rc4 |
|--------------|-----|-----|------|------|------|------|-----|
| HATVE (t) | 10 | 12 | 14.5 | 12.3 | 14 | 13.3 | 16 |
| GENİŞLİK (a) | 12 | 16 | 20 | | 31.0 | 24.6 | 31 |

SİSTEM WD ÖZEL SALGILI PİMLİ

| | WD 21 | WD24 | WD34 |
|--------------|-------|------|------|
| HATVE (t) | 11.30 | 14.5 | 14.5 |
| GENİŞLİK (a) | 21 | 24 | 34 |

GALLE ZİNCİRLERİ

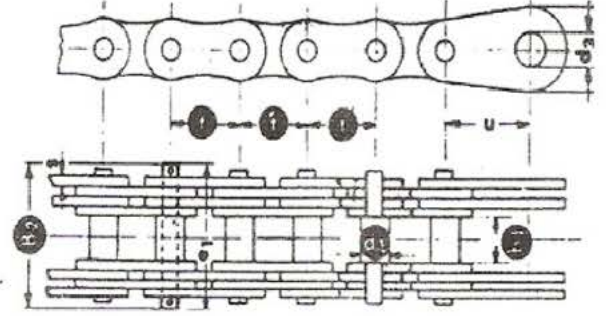

DIN 8150

| Nr. | Hatve t | | Makara Genişlik b ₁ | | Makara Kutru d ₁ | | Azami Genişlik B ₂ | | Plaka Adedi | Çalışma Sahası | | Sikiş | | Kopru Mukavemeti | |
|-------|------------|-----|-----------------------------------|-----|--------------------------------|-----|----------------------------------|-----|----------------|------------------|-----------------|--------|--------|------------------|--------|
| | inç | mm | inç | mm | inç | mm | inç | mm | | inç ² | mm ² | lb/ft. | Kg/mt | lb. | Kg. |
| G 3 | .138 | 3.5 | .0787 | 2 | .0787 | 2 | .276 | 7 | 2 | .0026 | 1.7 | .047 | .07 | 132 | 60 |
| G 4 | .165 | 4.2 | .0787 | 2 | .0787 | 2 | .283 | 7.2 | 2 | .003 | 1.95 | .054 | .08 | 154 | 70 |
| G 6/1 | .236 | 6 | .138 | 3.5 | .0984 | 2.5 | .323 | 8.2 | 2 | .0037 | 2.4 | .081 | .12 | 198 | 90 |
| G 6/2 | .236 | 6 | .157 | 4 | .118 | 3 | .443 | 11 | 2 | .007 | 4.6 | .108 | .16 | 286 | 130 |
| G 8 | .315 | 8 | .236 | 6 | .138 | 3.5 | .630 | 16 | 2 | .0078 | 5 | .168 | .25 | 330 | 150 |
| G 10 | .394 | 10 | .315 | 8 | .157 | 4 | .748 | 19 | 2 | .0140 | 9 | .269 | .40 | 550 | 250 |
| G 13 | .51 | 13 | .394 | 10 | .197 | 5 | .906 | 23 | 2 | .025 | 16 | .383 | .57 | 1100 | 500 |
| G 15 | .59 | 15 | .472 | 12 | .197 | 5 | 1.024 | 26 | 2 | .025 | 16 | .470 | .70 | 2100 | 950 |
| G 17 | .669 | 17 | .512 | 13 | .236 | 6 | 1.024 | 26 | 2 | .031 | 20 | .551 | .82 | 1650 | 750 |
| G 20 | .787 | 20 | .59 | 15 | .315 | 8 | 1.26 | 32 | 2 | .37 | 24 | .672 | 1.00 | 4150 | 1880 |
| G 25 | .984 | 25 | .709 | 18 | .394 | 10 | 1.614 | 41 | 2 | .074 | 48 | 1.223 | 1.82 | 8300 | 3750 |
| G 30 | 1.181 | 30 | .787 | 20 | .433 | 11 | 2.126 | 54 | 4 | .167 | 108 | 2.043 | 3.04 | 13200 | 6000 |
| G 35 | 1.378 | 35 | .866 | 22 | .472 | 12 | 2.362 | 60 | 4 | .186 | 120 | 2.654 | 3.95 | 19850 | 9000 |
| G 40 | 1.575 | 40 | .984 | 25 | .551 | 14 | 2.56 | 65 | 4 | .223 | 144 | 3.427 | 5.10 | 26450 | 12000 |
| G 45 | 1.772 | 45 | 1.181 | 30 | .669 | 17 | 2.677 | 68 | 4 | .26 | 168 | 4.402 | 6.55 | 33100 | 15000 |
| G 50 | 1.968 | 50 | 1.378 | 35 | .866 | 22 | 3.70 | 94 | 4 | .502 | 324 | 7.594 | 11.30 | 49600 | 22500 |
| G 55 | 2.165 | 55 | 1.575 | 40 | .945 | 24 | 4.173 | 106 | 4 | .781 | 504 | 9.744 | 14.50 | 66150 | 30000 |
| G 60 | 2.362 | 60 | 1.772 | 45 | 1.024 | 26 | 4.685 | 119 | 4 | .856 | 552 | 11.491 | 17.10 | 82700 | 37500 |
| G 65 | 2.56 | 65 | 1.772 | 45 | 1.102 | 28 | 4.882 | 124 | 6 | 1.046 | 675 | 13.507 | 20.10 | 99200 | 45000 |
| G 70 | 2.756 | 70 | 1.969 | 50 | 1.26 | 32 | 5.748 | 146 | 6 | 1.565 | 1010 | 21.504 | 32.00 | 123500 | 56000 |
| G 75 | 2.953 | 75 | 2.165 | 55 | 1.339 | 34 | 6.299 | 160 | 6 | 1.395 | 900 | 23.520 | 35.00 | 93500 | 42500 |
| G 80 | 3.15 | 80 | 2.362 | 60 | 1.417 | 36 | 6.693 | 170 | 6 | 1.786 | 1152 | 25.670 | 38.20 | 110000 | 50000 |
| G 85 | 3.347 | 85 | 2.56 | 65 | 1.496 | 38 | 7.717 | 196 | 8 | 2.108 | 1360 | 31.584 | 47.00 | 136400 | 62000 |
| G 90 | 3.543 | 90 | 2.756 | 70 | 1.575 | 40 | 7.835 | 199 | 6 | 2.356 | 1520 | 35.616 | 53.00 | 165000 | 75000 |
| G 100 | 3.937 | 100 | 3.15 | 80 | 1.772 | 45 | 9.37 | 238 | 8 | 3.557 | 2295 | 51.542 | 76.70 | 220000 | 100000 |
| G 110 | 4.33 | 110 | 3.543 | 90 | 1.969 | 50 | 9.843 | 250 | 8 | 3.918 | 2528 | 60.48 | 90.00 | 275000 | 125000 |
| G 120 | 4.72 | 120 | 3.937 | 100 | 2.165 | 55 | 10.866 | 276 | 8 | 4.96 | 3200 | 75.264 | 112.00 | 330000 | 150000 |

DIŞLI ÇAPINA GÖRE DIŞ SAYISINI GÖSTERİR

| Diş Adedi | 8.00 mm | 3/8 9.53 mm | 1/2 12.70 mm | 5/8 15.88 mm | 3/4 19.05 mm | 1 25.40 mm | 1 1/4 31.75 mm | 1.5 38.10 mm | 1 3/4 44.45 mm | 2 50.80 mm | 2.5 63.50 mm | 3 76.20 mm | 3.5 88.90 mm | 4 101.60 mm |
|-----------|------------|-------------------|--------------------|--------------------|--------------------|------------------|----------------------|--------------------|----------------------|------------------|--------------------|------------------|--------------------|-------------------|
| 9 | 28.7 | 33.5 | 44.5 | 56.4 | 68.1 | 90.9 | 114.8 | 133.9 | 158.8 | 186.0 | 227.9 | 271.8 | 320.8 | 363.7 |
| 10 | 30.7 | 35.8 | 47.8 | 60.5 | 72.9 | 97.6 | 123.2 | 143.8 | 170.5 | 199.2 | 244.4 | 291.6 | 343.9 | 389.9 |
| 11 | 32.8 | 38.6 | 51.3 | 64.8 | 78.0 | 104.4 | 131.9 | 154.0 | 182.4 | 212.9 | 261.4 | 312.2 | 367.8 | 417.3 |
| 12 | 35.1 | 41.2 | 54.9 | 69.4 | 83.3 | 111.5 | 140.5 | 164.6 | 194.8 | 226.8 | 279.2 | 333.3 | 392.4 | 445.8 |
| 13 | 38.4 | 45.0 | 60.0 | 75.5 | 91.0 | 121.4 | 152.9 | 180.1 | 212.4 | 246.2 | 304.1 | 363.5 | 427.2 | 485.7 |
| 14 | 40.7 | 47.8 | 63.8 | 80.3 | 96.5 | 129.1 | 162.3 | 191.9 | 225.3 | 261.1 | 322.6 | 385.8 | 453.4 | 515.6 |
| 15 | 43.0 | 50.6 | 67.6 | 84.9 | 102.1 | 136.4 | 171.7 | 202.7 | 238.8 | 276.4 | 341.6 | 408.7 | 479.8 | 545.9 |
| 16 | 45.5 | 53.6 | 71.4 | 89.7 | 108.0 | 144.0 | 181.1 | 214.2 | 252.0 | 291.6 | 360.7 | 431.6 | 506.5 | 576.3 |
| 17 | 47.8 | 56.4 | 75.2 | 94.5 | 113.6 | 151.9 | 190.8 | 225.6 | 265.5 | 306.9 | 379.7 | 454.4 | 533.4 | 607.1 |
| 18 | 50.3 | 59.2 | 79.0 | 99.3 | 119.4 | 159.5 | 200.4 | 237.3 | 278.9 | 322.4 | 399.3 | 477.8 | 560.3 | 638.1 |
| 19 | 52.6 | 62.2 | 82.8 | 104.2 | 125.2 | 167.4 | 210.1 | 248.7 | 292.6 | 337.9 | 418.6 | 500.9 | 587.5 | 669.1 |
| 20 | 55.9 | 66.3 | 88.4 | 110.8 | 133.1 | 177.8 | 222.8 | 265.0 | 310.7 | 356.9 | 444.3 | 532.4 | 622.8 | 710.5 |
| 21 | 58.4 | 69.1 | 92.2 | 115.8 | 139.2 | 185.7 | 232.4 | 276.6 | 324.4 | 372.6 | 464.1 | 556.0 | 650.5 | 742.0 |
| 22 | 61.0 | 72.2 | 96.3 | 120.7 | 145.1 | 193.6 | 242.3 | 288.6 | 338.4 | 388.6 | 483.8 | 579.7 | 678.2 | 773.5 |
| 23 | 63.5 | 75.2 | 100.1 | 125.8 | 150.9 | 201.4 | 252.2 | 300.3 | 352.1 | 404.4 | 503.7 | 606.3 | 705.9 | 805.2 |
| 24 | 65.8 | 78.3 | 104.2 | 130.6 | 157.0 | 209.3 | 262.2 | 312.2 | 366.0 | 420.2 | 523.5 | 627.1 | 733.6 | 837.0 |
| 25 | 68.4 | 81.0 | 108.2 | 135.7 | 162.8 | 217.4 | 272.1 | 324.1 | 380.0 | 436.2 | 543.3 | 651.0 | 761.5 | 868.7 |
| 26 | 70.9 | 84.1 | 112.0 | 140.5 | 168.9 | 225.3 | 282.0 | 336.1 | 393.7 | 451.9 | 563.1 | 674.9 | 789.2 | 900.5 |
| 27 | 73.4 | 86.9 | 115.8 | 145.6 | 174.8 | 233.2 | 292.1 | 347.8 | 407.7 | 468.4 | 583.2 | 698.8 | 817.4 | 932.5 |
| 28 | 76.0 | 89.9 | 119.9 | 150.4 | 180.9 | 241.3 | 302.0 | 359.7 | 421.7 | 484.1 | 603.3 | 722.7 | 845.3 | 964.2 |
| 29 | 78.5 | 93.0 | 124.0 | 155.5 | 186.7 | 249.2 | 312.2 | 371.6 | 435.6 | 500.1 | 623.1 | 746.5 | 873.3 | 996.2 |
| 30 | 81.0 | 96.0 | 127.8 | 160.6 | 192.8 | 257.3 | 322.1 | 383.8 | 449.6 | 516.1 | 643.2 | 770.4 | 901.2 | 1028.2 |
| 31 | 83.6 | 99.1 | 131.9 | 165.4 | 198.6 | 265.2 | 332.0 | 395.8 | 463.6 | 532.1 | 663.0 | 794.5 | 929.1 | 1060.2 |
| 32 | 86.1 | 101.9 | 135.9 | 170.5 | 204.7 | 273.3 | 342.2 | 407.7 | 477.6 | 548.1 | 683.0 | 814.4 | 957.1 | 1092.2 |
| 33 | 88.4 | 104.9 | 140.0 | 175.5 | 210.8 | 281.2 | 352.1 | 419.6 | 491.8 | 564.1 | 703.0 | 842.5 | 985.3 | 1124.2 |
| 34 | 91.0 | 108.0 | 143.8 | 180.4 | 216.7 | 289.3 | 362.0 | 431.8 | 505.7 | 580.2 | 723.2 | 866.4 | 1013.2 | 1156.2 |
| 35 | 93.5 | 111.0 | 147.9 | 185.4 | 222.8 | 297.2 | 372.1 | 443.8 | 519.7 | 596.2 | 743.2 | 890.5 | 1041.2 | 1188.2 |
| 36 | 96.0 | 114.1 | 151.9 | 190.5 | 228.9 | 305.3 | 382.0 | 455.8 | 533.7 | 612.2 | 763.0 | 914.7 | 1069.4 | 1220.2 |
| 37 | 98.6 | 116.9 | 156.0 | 195.6 | 234.7 | 313.2 | 392.2 | 467.9 | 547.7 | 628.4 | 783.1 | 938.8 | 1097.3 | 1252.5 |
| 38 | 101.1 | 119.9 | 160.0 | 200.4 | 240.8 | 321.3 | 402.1 | 479.8 | 561.9 | 644.4 | 803.2 | 962.7 | 1125.5 | 1284.5 |
| 39 | 103.7 | 123.0 | 163.8 | 205.5 | 246.9 | 329.2 | 412.3 | 491.8 | 575.9 | 660.4 | 823.2 | 986.8 | 1153.7 | 1316.5 |
| 40 | 106.2 | 126.0 | 167.9 | 210.6 | 252.8 | 337.3 | 422.4 | 503.7 | 589.8 | 676.9 | 843.5 | 1010.9 | 1181.9 | 1348.8 |
| 41 | 108.7 | 129.0 | 172.0 | 215.4 | 258.9 | 345.5 | 432.3 | 515.6 | 604.0 | 692.9 | 863.6 | 1035.1 | 1210.1 | 1381.0 |
| 42 | 111.3 | 132.1 | 175.8 | 220.5 | 264.9 | 353.3 | 442.5 | 527.8 | 618.0 | 708.9 | 883.7 | 1059.2 | 1238.3 | 1413.0 |
| 43 | 113.8 | 134.9 | 179.8 | 225.6 | 270.8 | 361.5 | 452.4 | 539.8 | 632.2 | 725.2 | 903.8 | 1083.3 | 1266.5 | 1445.3 |
| 44 | 116.4 | 138.0 | 183.9 | 230.7 | 276.9 | 369.6 | 462.6 | 552.0 | 646.2 | 741.2 | 923.8 | 1107.5 | 1294.4 | 1477.3 |
| 45 | 118.9 | 141.0 | 188.0 | 235.7 | 283.0 | 377.5 | 472.7 | 563.9 | 660.2 | 757.2 | 943.8 | 1131.6 | 1322.6 | 1509.5 |
| 46 | 121.4 | 144.0 | 192.0 | 240.6 | 289.1 | 385.6 | 482.6 | 576.1 | 674.4 | 773.5 | 964.2 | 1155.7 | 1350.8 | 1540.5 |
| 47 | 124.0 | 147.1 | 196.1 | 245.6 | 294.9 | 393.7 | 492.8 | 588.0 | 688.4 | 789.5 | 984.3 | 1179.9 | 1379.0 | 1572.8 |
| 48 | 126.5 | 150.1 | 199.9 | 250.7 | 301.0 | 401.6 | 502.7 | 600.2 | 702.6 | 805.5 | 1004.3 | 1204.0 | 1407.2 | 1605.3 |
| 49 | 129.1 | 153.2 | 204.0 | 255.8 | 307.1 | 409.7 | 512.8 | 612.2 | 716.6 | 821.7 | 1024.4 | 1228.1 | 1435.4 | 1637.6 |
| 50 | 131.6 | 156.2 | 208.0 | 260.9 | 313.2 | 417.9 | 523.0 | 624.3 | 730.8 | 837.7 | 1044.5 | 1252.2 | 1463.6 | 1669.8 |
| 51 | 134.1 | 159.0 | 212.1 | 265.7 | 319.0 | 425.7 | 532.9 | 635.3 | 744.8 | 853.7 | 1064.8 | 1276.4 | 1491.5 | 1702.1 |
| 52 | 136.7 | 162.1 | 216.2 | 270.8 | 325.1 | 433.9 | 543.1 | 648.5 | 758.7 | 870.0 | 1084.8 | 1300.5 | 1519.7 | 1734.6 |
| 53 | 139.2 | 165.1 | 220.2 | 275.9 | 331.2 | 442.0 | 553.2 | 660.4 | 773.0 | 886.0 | 1104.9 | 1324.6 | 1547.9 | 1766.8 |
| 54 | 141.8 | 168.2 | 224.3 | 280.9 | 337.3 | 450.1 | 563.2 | 672.6 | 786.9 | 902.2 | 1125.2 | 1348.8 | 1576.1 | 1799.1 |
| 55 | 144.3 | 171.2 | 228.1 | 286.0 | 343.4 | 458.0 | 573.3 | 684.6 | 801.2 | 918.2 | 1145.3 | 1372.9 | 1604.3 | 1831.4 |
| 56 | 146.8 | 174.3 | 232.2 | 290.9 | 349.3 | 466.1 | 583.2 | 696.7 | 815.1 | 934.5 | 1165.4 | 1397.3 | 1632.5 | 1863.9 |
| 57 | 149.4 | 177.3 | 236.2 | 295.9 | 355.4 | 474.2 | 593.4 | 708.9 | 829.3 | 950.5 | 1185.4 | 1421.4 | 1660.9 | 1896.1 |
| 58 | 152.0 | 180.4 | 240.3 | 301.0 | 361.5 | 482.1 | 603.5 | 720.9 | 843.6 | 966.5 | 1205.8 | 1445.5 | 1689.1 | 1928.3 |
| 59 | 154.4 | 183.4 | 244.4 | 306.1 | 367.6 | 490.2 | 613.4 | 733.1 | 857.5 | 982.7 | 1225.8 | 1469.7 | 1717.3 | 1960.6 |
| 60 | 157.0 | 186.2 | 248.4 | 311.2 | 373.7 | 498.4 | 623.6 | 745.0 | 871.7 | 998.7 | 1245.9 | 1493.8 | 1745.5 | 1993.2 |
| 61 | 159.5 | 189.3 | 252.5 | 316.3 | 379.5 | 506.5 | 633.8 | 757.2 | 885.7 | 1015.0 | 1266.2 | 1518.2 | 1773.7 | 2025.4 |
| 62 | 162.1 | 192.3 | 256.3 | 321.1 | 385.6 | 514.4 | 643.7 | 769.4 | 899.9 | 1031.0 | 1286.3 | 1542.3 | 1801.9 | 2057.7 |
| 63 | 164.6 | 195.4 | 260.4 | 326.2 | 391.7 | 522.5 | 653.8 | 781.3 | 913.9 | 1047.3 | 1306.3 | 1566.4 | 1830.1 | 2089.4 |
| 64 | 167.2 | 198.4 | 264.4 | 331.2 | 397.8 | 530.6 | 664.0 | 793.5 | 928.2 | 1063.3 | 1326.7 | 1590.6 | 1858.3 | 2121.7 |
| 65 | 169.7 | 201.4 | 268.5 | 336.3 | 403.9 | 538.7 | 674.1 | 805.7 | 942.1 | 1079.5 | 1346.7 | 1615.0 | 1886.5 | 2153.9 |
| 66 | 172.2 | 204.5 | 272.6 | 341.4 | 409.7 | 546.6 | 684.0 | 817.6 | 956.3 | 1095.5 | 1367.1 | 1639.1 | 1914.7 | 2186.2 |
| 67 | 174.8 | 207.5 | 276.6 | 346.5 | 415.8 | 554.8 | 694.2 | 829.8 | 970.6 | 1111.8 | 1387.1 | 1663.2 | 1943.1 | 2218.4 |
| 68 | 177.3 | 210.6 | 280.7 | 351.6 | 421.9 | 562.9 | 704.4 | 841.8 | 984.5 | 1127.8 | 1407.2 | 1687.3 | 1971.3 | 2250.7 |
| 69 | 179.9 | 213.6 | 284.8 | 356.4 | 428.0 | 571.0 | 714.3 | 854.0 | 998.8 | 1144.0 | 1427.5 | 1711.7 | 1999.5 | 2283.0 |
| 70 | 182.4 | 216.7 | 288.6 | 361.4 | 434.1 | 578.9 | 724.4 | 866.2 | 1012.7 | 1160.0 | 1447.6 | 1735.9 | 2027.7 | 2315.2 |
| 71 | 184.9 | 219.5 | 292.6 | 366.5 | 440.2 | 587.0 | 734.6 | 878.1 | 1026.9 | 1176.3 | 1467.9 | 1760.0 | 2055.9 | 2347.5 |
| 72 | 187.5 | 222.5 | 296.7 | 371.6 | 446.0 | 595.1 | 744.5 | 890.3 | 1040.9 | 1192.3 | 1487.9 | 1784.1 | 2084.1 | 2380.0 |
| 73 | 190.0 | 225.4 | 300.8 | 376.7 | 452.1 | 603.3 | 754.7 | 902.5 | 1055.2 | 1208.5 | 1508.1 | 1808.5 | 2112.5 | 2412.3 |
| 74 | 192.5 | 228.6 | 304.8 | 381.8 | 458.2 | 611.1 | 764.8 | 914.4 | 1069.4 | 1224.8 | 1528.3 | 1832.6 | 2140.7 | 2444.5 |
| 75 | 195.1 | 231.7 | 308.9 | 386.9 | 464.3 | 619.3 | 775.0 | 926.6 | 1083.3 | 1240.8 | 1548.4 | 1856.8 | 2168.9 | 2476.8 |
| 76 | 197.6 | 234.7 | 313.0 | 391.7 | 470.4 | 627.4 | 784.9 | 938.8 | 1097.5 | 1257.1 | 1568.7 | 1881.1 | 2197.1 | 2509.0 |
| 77 | 200.2 | 237.8 | 317.0 | 396.8 | 476.5 | 635.5 | 795.0 | 950.7 | 1111.5 | 1273.1 | 1588.8 | 1905.3 | 2225.3 | 2541.3 |
| 78 | 202.7 | 240.8 | 321.1 | 401.9 | 482.4 | 643.7 | 805.2 | 962.9 | 1125.8 | 1289.3 | 1609.1 | 1929.4 | 2253.8 | 2573.5 |
| 79 | 205.2 | 243.9 | 324.9 | 406.9 | 488.5 | 651.5 | 815.1 | 975.1 | 1140.0 | 1305.3 | 1629.2 | 1953.8 | 2282.0 | 2605.8 |
| 80 | 207.8 | 246.9 | 329.0 | 412.0 | 494.6 | 659.7 | 825.5 | 986.8 | 1154.0 | 1321.8 | 1649.5 | 1977.9 | 2310.4 | 2638.3 |

CETVEL

DIŞLİ ÇAPINA GÖRE DIŞ SAYISINI GÖSTERİR

| Diş Adedi | 8.00 mm | 3/8 9.53 mm | 1/2 12.70 mm | 5/8 15.88 mm | 3/4 19.05 mm | 1 25.40 mm | 1 1/4 31.75 mm | 1.5 38.10 mm | 1 3/4 44.45 mm | 2 50.80 mm | 2.5 63.50 mm | 3 76.20 mm | 3.5 88.90 mm | 4 101.60 mm |
|-----------|------------|-------------------|--------------------|--------------------|--------------------|------------------|----------------------|--------------------|----------------------|------------------|--------------------|------------------|--------------------|-------------------|
| 81 | 210.3 | 249.7 | 333.0 | 417.1 | 500.7 | 667.8 | 835.4 | 999.0 | 1168.2 | 1338.1 | 1669.6 | 2002.1 | 2338.6 | 2670.6 |
| 82 | 212.9 | 252.8 | 337.1 | 421.9 | 506.8 | 675.9 | 845.6 | 1011.2 | 1182.4 | 1354.1 | 1689.9 | 2026.0 | 2367.0 | 2702.8 |
| 83 | 215.4 | 255.8 | 341.1 | 427.0 | 512.6 | 683.6 | 855.8 | 1023.1 | 1196.4 | 1370.4 | 1710.0 | 2050.6 | 2395.2 | 2735.1 |
| 84 | 217.9 | 258.9 | 345.2 | 432.1 | 518.7 | 691.9 | 865.9 | 1035.3 | 1210.6 | 1386.6 | 1730.3 | 2074.7 | 2423.4 | 2767.3 |
| 85 | 220.5 | 261.9 | 349.3 | 437.2 | 524.8 | 700.0 | 875.8 | 1047.5 | 1224.6 | 1402.6 | 1750.3 | 2099.1 | 2451.6 | 2799.6 |
| 86 | 223.0 | 264.9 | 353.1 | 442.2 | 530.9 | 708.2 | 886.0 | 1059.5 | 1238.8 | 1418.9 | 1770.7 | 2123.2 | 2480.1 | 2831.9 |
| 87 | 225.6 | 268.0 | 357.1 | 447.3 | 537.0 | 716.3 | 896.0 | 1071.7 | 1253.0 | 1434.9 | 1790.7 | 2147.3 | 2508.3 | 2864.1 |
| 88 | 228.1 | 271.0 | 361.2 | 452.4 | 543.1 | 724.2 | 906.3 | 1083.9 | 1267.0 | 1451.1 | 1811.0 | 2171.7 | 2536.5 | 2896.6 |
| 89 | 230.7 | 274.1 | 365.3 | 457.2 | 548.9 | 732.3 | 916.2 | 1095.8 | 1281.2 | 1467.1 | 1831.1 | 2195.9 | 2564.7 | 2928.9 |
| 90 | 233.2 | 277.1 | 369.3 | 462.3 | 555.0 | 740.4 | 926.4 | 1108.0 | 1295.4 | 1483.4 | 1851.4 | 2220.0 | 2593.1 | 2961.1 |
| 91 | 235.7 | 280.2 | 373.4 | 467.4 | 561.1 | 748.6 | 936.5 | 1120.2 | 1309.4 | 1499.6 | 1871.5 | 2244.4 | 2621.3 | 2993.4 |
| 92 | 238.3 | 283.2 | 377.5 | 472.5 | 567.2 | 756.7 | 946.4 | 1132.1 | 1323.6 | 1515.6 | 1891.8 | 2268.5 | 2649.5 | 3025.7 |
| 93 | 240.8 | 286.0 | 381.5 | 477.5 | 573.3 | 764.6 | 956.6 | 1144.3 | 1337.6 | 1531.9 | 1911.9 | 2292.9 | 2677.7 | 3057.9 |
| 94 | 243.9 | 289.1 | 385.6 | 482.6 | 579.4 | 772.7 | 966.8 | 1156.5 | 1351.8 | 1547.9 | 1932.0 | 2317.0 | 2706.1 | 3090.4 |
| 95 | 245.9 | 292.1 | 389.7 | 487.7 | 585.5 | 780.8 | 976.9 | 1168.4 | 1366.0 | 1564.2 | 1952.3 | 2341.1 | 2734.3 | 3122.7 |
| 96 | 248.4 | 295.2 | 393.5 | 492.8 | 591.3 | 789.0 | 986.8 | 1180.6 | 1380.0 | 1580.2 | 1972.3 | 2365.5 | 2762.5 | 3155.0 |
| 97 | 251.0 | 298.2 | 397.5 | 497.6 | 597.4 | 797.1 | 997.0 | 1192.8 | 1394.2 | 1596.4 | 1992.7 | 2389.7 | 2791.0 | 3187.2 |
| 98 | 253.5 | 301.3 | 401.6 | 502.7 | 603.5 | 805.0 | 1007.1 | 1204.7 | 1408.4 | 1612.7 | 2012.7 | 2413.8 | 2819.2 | 3219.5 |
| 99 | 256.1 | 304.3 | 405.7 | 507.8 | 609.6 | 813.1 | 1017.3 | 1216.9 | 1422.4 | 1628.7 | 2033.0 | 2438.2 | 2847.4 | 3251.7 |
| 100 | 258.6 | 307.4 | 409.7 | 512.9 | 615.7 | 821.2 | 1027.2 | 1229.1 | 1436.6 | 1644.9 | 2053.1 | 2462.7 | 2875.6 | 3284.0 |
| 101 | 261.1 | 310.4 | 413.8 | 517.9 | 621.8 | 829.3 | 1037.4 | 1241.3 | 1450.9 | 1660.9 | 2073.4 | 2486.7 | 2904.0 | 3316.5 |
| 102 | 263.7 | 313.5 | 417.9 | 523.0 | 627.7 | 837.2 | 1047.5 | 1253.3 | 1464.9 | 1677.2 | 2093.5 | 2510.8 | 2932.2 | 3348.8 |
| 103 | 266.2 | 316.5 | 421.9 | 528.1 | 633.8 | 845.3 | 1057.7 | 1265.5 | 1479.1 | 1693.4 | 2113.8 | 2535.0 | 2960.4 | 3381.0 |
| 104 | 268.8 | 319.5 | 426.0 | 533.2 | 639.9 | 853.5 | 1067.6 | 1277.7 | 1493.3 | 1709.4 | 2133.9 | 2559.3 | 2988.9 | 3413.3 |
| 105 | 271.3 | 322.6 | 430.0 | 538.0 | 646.0 | 861.6 | 1077.7 | 1289.6 | 1507.3 | 1725.7 | 2154.2 | 2583.5 | 3017.0 | 3445.8 |
| 106 | 273.8 | 325.4 | 433.9 | 543.1 | 652.0 | 869.7 | 1087.9 | 1301.3 | 1521.5 | 1741.7 | 2174.3 | 2607.8 | 3045.2 | 3478.0 |
| 107 | 276.4 | 328.4 | 437.9 | 548.2 | 658.1 | 877.8 | 1098.1 | 1314.0 | 1535.5 | 1758.0 | 2194.6 | 2632.0 | 3073.7 | 3510.3 |
| 108 | 278.9 | 331.5 | 442.0 | 553.5 | 664.2 | 885.7 | 1108.0 | 1325.9 | 1549.7 | 1774.2 | 2214.7 | 2656.1 | 3101.9 | 3542.6 |
| 109 | 281.5 | 334.5 | 446.0 | 558.3 | 670.1 | 893.9 | 1118.1 | 1338.1 | 1563.9 | 1790.2 | 2235.0 | 2680.5 | 3130.0 | 3574.8 |
| 110 | 284.0 | 337.6 | 450.1 | 563.4 | 676.2 | 902.0 | 1128.3 | 1350.3 | 1577.9 | 1806.5 | 2255.0 | 2704.6 | 3158.3 | 3607.3 |
| 111 | 286.5 | 340.6 | 454.2 | 568.5 | 682.3 | 910.1 | 1138.5 | 1362.5 | 1592.1 | 1822.5 | 2275.4 | 2729.0 | 3186.7 | 3639.6 |
| 112 | 289.1 | 343.7 | 458.2 | 573.5 | 688.4 | 918.2 | 1148.4 | 1374.4 | 1606.3 | 1838.7 | 2295.4 | 2753.1 | 3214.9 | 3671.8 |
| 113 | 291.6 | 346.7 | 462.3 | 578.4 | 694.5 | 926.1 | 1158.5 | 1386.6 | 1620.3 | 1855.0 | 2315.7 | 2777.3 | 3243.1 | 3704.1 |
| 114 | 294.2 | 349.8 | 466.4 | 583.5 | 700.6 | 934.2 | 1168.7 | 1398.6 | 1634.5 | 1871.0 | 2335.8 | 2801.6 | 3271.5 | 3736.6 |
| 115 | 296.7 | 352.8 | 470.4 | 588.5 | 706.7 | 942.4 | 1178.8 | 1410.8 | 1648.7 | 1887.2 | 2356.1 | 2825.8 | 3299.7 | 3768.9 |
| 116 | 299.2 | 355.9 | 474.2 | 593.6 | 712.5 | 950.5 | 1188.7 | 1422.9 | 1662.9 | 1903.5 | 2376.2 | 2850.1 | 3327.9 | 3801.1 |
| 117 | 301.8 | 358.9 | 478.3 | 598.7 | 718.6 | 958.6 | 1198.9 | 1435.1 | 1676.9 | 1919.5 | 2396.5 | 2874.3 | 3356.4 | 3833.4 |
| 118 | 304.3 | 362.0 | 482.4 | 603.8 | 724.7 | 966.5 | 1209.1 | 1447.3 | 1691.2 | 1935.7 | 2416.8 | 2898.7 | 3384.6 | 3865.6 |
| 119 | 306.9 | 365.0 | 486.4 | 608.9 | 730.8 | 974.6 | 1219.2 | 1459.3 | 1705.1 | 1951.7 | 2436.9 | 2922.8 | 3412.8 | 3897.9 |
| 120 | 309.4 | 367.8 | 490.5 | 613.9 | 736.9 | 982.8 | 1229.4 | 1471.4 | 1719.4 | 1968.0 | 2457.2 | 2946.9 | 3441.2 | 3930.4 |
| 121 | 311.9 | 370.9 | 494.6 | 618.8 | 743.0 | 990.9 | 1239.3 | 1483.6 | 1733.6 | 1984.3 | 2477.3 | 2971.3 | 3469.4 | 3962.7 |
| 122 | 314.5 | 373.9 | 498.6 | 623.8 | 749.1 | 999.0 | 1249.5 | 1495.6 | 1747.6 | 2000.3 | 2497.6 | 2995.4 | 3497.6 | 3995.0 |
| 123 | 317.0 | 377.0 | 502.7 | 628.9 | 755.2 | 1006.9 | 1259.6 | 1507.8 | 1761.8 | 2016.5 | 2517.7 | 3019.8 | 3526.0 | 4027.4 |
| 124 | 319.6 | 380.0 | 506.7 | 634.0 | 761.0 | 1015.0 | 1269.8 | 1520.0 | 1776.0 | 2032.5 | 2538.0 | 3044.0 | 3554.2 | 4059.7 |
| 125 | 322.4 | 383.3 | 510.8 | 639.1 | 767.1 | 1023.1 | 1279.7 | 1532.2 | 1790.0 | 2048.8 | 2558.0 | 3068.3 | 3582.4 | 4092.0 |
| 126 | 324.9 | 386.1 | 514.6 | 644.2 | 773.2 | 1031.3 | 1289.8 | 1544.1 | 1804.2 | 2065.0 | 2578.4 | 3092.5 | 3610.9 | 4124.2 |
| 127 | 327.4 | 389.1 | 518.7 | 649.2 | 779.3 | 1039.4 | 1300.0 | 1556.3 | 1818.4 | 2081.0 | 2598.4 | 3116.6 | 3639.1 | 4156.7 |
| 128 | 330.0 | 392.2 | 522.7 | 654.3 | 785.4 | 1047.5 | 1310.2 | 1568.5 | 1832.4 | 2097.3 | 2618.8 | 3141.0 | 3667.3 | 4189.0 |
| 129 | 332.5 | 395.2 | 526.8 | 659.4 | 791.5 | 1055.4 | 1320.1 | 1580.4 | 1846.6 | 2113.5 | 2638.8 | 3165.1 | 3695.7 | 4221.2 |
| 130 | 335.1 | 398.3 | 530.9 | 664.2 | 797.3 | 1063.5 | 1330.2 | 1592.6 | 1860.8 | 2129.5 | 2659.2 | 3189.5 | 3723.9 | 4253.5 |
| 131 | 337.6 | 401.3 | 534.9 | 669.3 | 803.4 | 1071.7 | 1340.4 | 1604.8 | 1874.8 | 2145.8 | 2679.2 | 3213.6 | 3752.1 | 4285.8 |
| 132 | 340.1 | 404.4 | 539.0 | 674.4 | 809.5 | 1079.8 | 1350.5 | 1617.0 | 1889.0 | 2161.8 | 2699.5 | 3238.0 | 3780.6 | 4318.3 |
| 133 | 342.7 | 407.4 | 543.1 | 679.5 | 815.6 | 1087.7 | 1360.4 | 1629.9 | 1903.2 | 2178.1 | 2719.6 | 3262.1 | 3808.8 | 4350.5 |
| 134 | 345.2 | 410.2 | 547.1 | 684.6 | 821.7 | 1095.8 | 1370.6 | 1641.1 | 1917.2 | 2194.3 | 2739.9 | 3286.9 | 3836.9 | 4382.8 |
| 135 | 347.8 | 413.3 | 551.2 | 689.6 | 827.8 | 1103.9 | 1380.8 | 1653.3 | 1931.4 | 2210.3 | 2760.0 | 3310.5 | 3865.4 | 4415.3 |
| 136 | 350.3 | 416.3 | 555.3 | 694.7 | 833.9 | 1112.0 | 1390.9 | 1665.3 | 1945.7 | 2226.6 | 2780.3 | 3334.8 | 3893.6 | 4447.6 |
| 137 | 352.8 | 419.4 | 559.1 | 699.8 | 839.7 | 1120.2 | 1400.8 | 1677.5 | 1959.6 | 2242.8 | 2800.4 | 3359.2 | 3921.8 | 4479.9 |
| 138 | 355.4 | 422.4 | 563.1 | 704.6 | 845.8 | 1128.3 | 1411.0 | 1689.6 | 1973.9 | 2258.8 | 2820.7 | 3383.3 | 3950.2 | 4512.1 |
| 139 | 357.9 | 425.5 | 567.2 | 709.7 | 851.9 | 1136.2 | 1421.2 | 1701.8 | 1988.1 | 2275.1 | 2841.0 | 3407.7 | 3978.4 | 4544.6 |
| 140 | 360.5 | 428.5 | 571.3 | 714.8 | 858.0 | 1144.3 | 1431.3 | 1713.8 | 2002.1 | 2291.1 | 2861.1 | 3431.8 | 4006.6 | 4576.8 |
| 141 | 363.0 | 431.6 | 575.3 | 719.9 | 864.1 | 1152.4 | 1441.5 | 1726.0 | 2016.3 | 2307.4 | 2881.4 | 3456.2 | 4035.1 | 4609.1 |
| 142 | 365.5 | 434.6 | 579.4 | 724.9 | 870.2 | 1160.6 | 1451.4 | 1738.0 | 2030.5 | 2323.6 | 2901.5 | 3480.3 | 4063.3 | 4641.4 |
| 143 | 368.1 | 437.7 | 583.4 | 730.0 | 876.3 | 1168.7 | 1461.6 | 1750.1 | 2044.5 | 2339.6 | 2921.8 | 3504.4 | 4091.5 | 4673.9 |
| 144 | 370.6 | 440.7 | 587.5 | 735.1 | 882.2 | 1176.8 | 1471.7 | 1762.3 | 2058.9 | 2355.9 | 2941.9 | 3528.8 | 4119.9 | 4706.1 |
| 145 | 373.2 | 443.8 | 591.6 | 740.2 | 888.3 | 1184.7 | 1481.9 | 1774.5 | 2072.9 | 2372.1 | 2962.2 | 3553.0 | 4148.1 | 4738.4 |
| 146 | 375.7 | 446.8 | 595.6 | 745.3 | 894.4 | 1192.8 | 1491.8 | 1786.7 | 2086.9 | 2388.1 | 2982.2 | 3577.4 | 4176.3 | 4770.7 |
| 147 | 378.2 | 449.9 | 599.5 | 750.4 | 900.5 | 1200.9 | 1501.9 | 1798.6 | 2101.1 | 2404.4 | 3002.5 | 3601.5 | 4204.7 | 4803.2 |
| 148 | 380.8 | 452.7 | 603.5 | 755.2 | 906.6 | 1209.1 | 1512.1 | 1810.8 | 2115.3 | 2420.4 | 3022.6 | 3625.9 | 4232.9 | 4835.4 |
| 149 | 383.3 | 455.7 | 607.6 | 760.2 | 912.7 | 1217.2 | 1522.2 | 1823.0 | 2129.3 | 2436.6 | 3042.9 | 3650.0 | 4261.4 | 4867.7 |
| 150 | 385.9 | 458.8 | 611.6 | 765.3 | 918.8 | 1225.1 | 1532.1 | 1835.2 | 2143.5 | 2452.9 | 3063.0 | 3674.4 | 4289.6 | 4900.0 |

DOKUMA SANAYİNDE KULLANILAN ZİNCİRLER

HAFİF TİPİ GALLE DIN 8151 VE FABRİKA NORMU

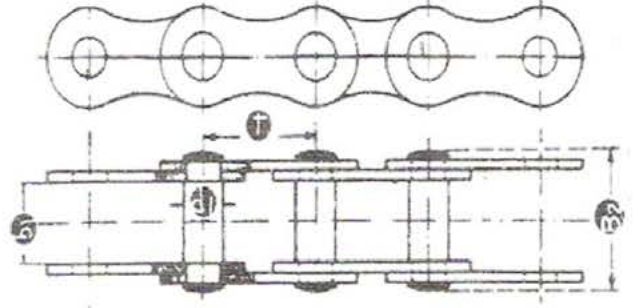

| Nr. | Hatve t | | İç Genişlik b ₁ | | Burç Kutru d ₁ | | Azami Genişlik B ₂ | | Plaka Adedi | Çalışma Sahası | | Siklet | | Kopma Mukavemeti | |
|-------|------------|----|-------------------------------|----|------------------------------|----|----------------------------------|----|----------------|------------------|-----------------|--------|-------|------------------|-------|
| | inç | mm | inç | mm | inç | mm | inç | mm | | inç ² | mm ² | lb/ft. | Kg/mt | lb. | Kg. |
| GL 20 | .787 | 20 | .315 | 8 | .157 | 4 | .748 | 19 | 2 | .014 | 9 | .181 | .27 | 550 | 250 |
| GL 25 | .984 | 25 | .472 | 12 | .197 | 5 | 1.024 | 26 | 2 | .025 | 16 | .242 | .36 | 1100 | 500 |
| GL 30 | 1.181 | 30 | .512 | 13 | .236 | 6 | 1.142 | 29 | 2 | .031 | 20 | .349 | .52 | 2200 | 1000 |
| GL 35 | 1.378 | 35 | .591 | 15 | .315 | 8 | 1.181 | 30 | 2 | .037 | 24 | .470 | .70 | 2750 | 1250 |
| GL 40 | 1.575 | 40 | .709 | 18 | .394 | 10 | 1.575 | 40 | 2 | .074 | 48 | .840 | 1.25 | 5500 | 2500 |
| GL 45 | 1.772 | 45 | .787 | 20 | .433 | 11 | 1.850 | 47 | 2 | .112 | 72 | 1.223 | 1.82 | 7150 | 3250 |
| GL 50 | 1.969 | 50 | .787 | 20 | .433 | 11 | 2.244 | 57 | 2 | .167 | 108 | 1.855 | 2.76 | 8800 | 4000 |
| GL 55 | 2.165 | 55 | .866 | 22 | .472 | 12 | 1.969 | 50 | 2 | .124 | 80 | 1.572 | 2.34 | 11000 | 5000 |
| GL 60 | 2.362 | 60 | .866 | 22 | .472 | 12 | 2.362 | 60 | 2 | .186 | 120 | 2.110 | 3.14 | 13200 | 6000 |
| GL 65 | 2.559 | 65 | .984 | 25 | .551 | 14 | 2.323 | 59 | 2 | .186 | 120 | 2.218 | 3.3 | 15400 | 7000 |
| GL 70 | 2.756 | 70 | .984 | 25 | .551 | 14 | 2.559 | 65 | 2 | .223 | 144 | 2.218 | 3.3 | 17600 | 8000 |
| GL 80 | 3.150 | 80 | 1.181 | 30 | .669 | 17 | 2.717 | 69 | 2 | .260 | 168 | 3.024 | 4.5 | 22000 | 10000 |

TARAK ŞAPKA ZİNCİRLERİ

| Nr. | a | | b | | c | | d | | Şapka Adedi | Siklet Kg/mt |
|-------|-------|------|-----------------|-------|-------------|-------|-----------------|--------|------------------|-----------------|
| | Hatve | | Boğaz Genişliği | | Delik Kutru | | Plaka Kalınlığı | | | |
| | mm | inç | mm | inç | mm | inç | mm | inç | | |
| D 100 | 36.5 | 1.38 | 10 | 0.394 | 9.5 | 0.375 | 2.5 | 0.0986 | 106'dan 110'a | 0.92 |
| D 101 | 36.5 | 1.38 | 13 | 0.512 | 9.5 | 0.375 | 2.5 | 0.0986 | 106'dan 110'a | 1 |
| D 102 | 36.5 | 1.38 | 17 | 0.671 | 9.5 | 0.375 | 2.5 | 0.0986 | 106'dan 110'a | 1.1 |
| D 103 | 38.1 | 1.5 | 13 | 0.512 | 10 | 0.394 | 3 | 0.118 | 110 | 1.15 |

MAKARALI ZİNCİRLER

| Nr. | a | | b | | c | | d | | Kopma Mukavemeti Kg. | Siklet Kg/mt |
|-------|-------|-------|-----------------|-------|-------------|-------|-----------------|--------|----------------------------|-----------------|
| | Hatve | | Boğaz Genişliği | | Delik Kutru | | Plaka Kalınlığı | | | |
| | mm | inç | mm | inç | mm | inç | mm | inç | | |
| J 101 | 14 | 0.525 | 7 | 0.277 | 11 | 0.433 | 2 | 0.0791 | 800 | 0.7 |
| J 102 | 15.87 | 0.62 | 9 | 0.355 | 11 | 0.433 | 2 | 0.0791 | 1000 | 1 |
| J 103 | 16.25 | 0.63 | 9 | 0.355 | 11 | 0.433 | 2.5 | 0.0986 | 1250 | 1.1 |
| J 104 | 16.34 | 0.635 | 9 | 0.355 | 11 | 0.433 | 2.5 | 0.0986 | 1250 | 1.1 |
| J 105 | 20 | 0.78 | 9 | 0.355 | 15 | 0.7 | 2.5 | 0.0986 | 1500 | 2 |

DİŐLİ - DİŐLİ KAPLİNLERİ - V KASNAKLARI KONİK SIKMA BURÇLARI

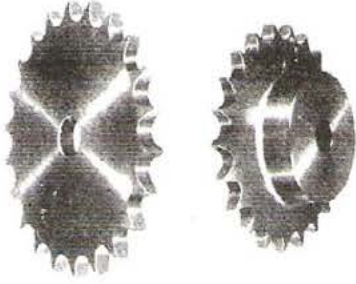

6 MM. den 3 parmak hatveli
zincirler için diŐli imalatı

Flanjlı - Gbekli
Tek sıralı
Çelik

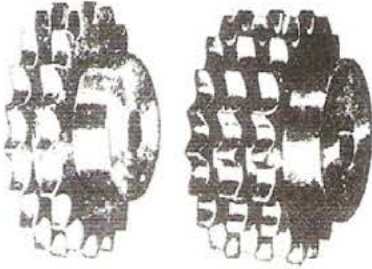

İki sıralı
Üç sıralı
Çelik

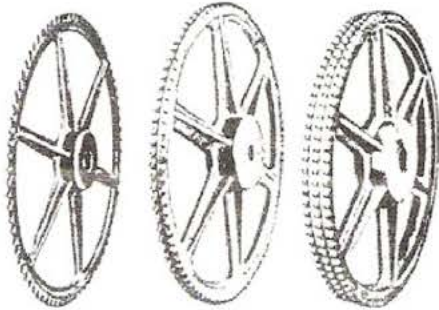

Tek sıralı
İki sıralı
Üç sıralı
Pik diŐlileri

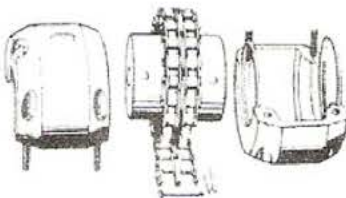

Zincirli diŐli kaplinleri

TAŞIMA ZİNCİRLERİ

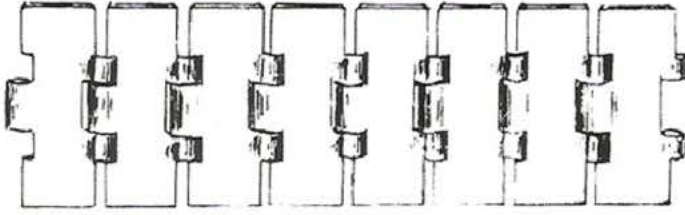

Paslanmaz çelikten Şişe Yürütme Zincirleri

Hatve : 1.50"
Genişlikleri : 82.50-101.60-114.30 mm
152.40-190.50 mm

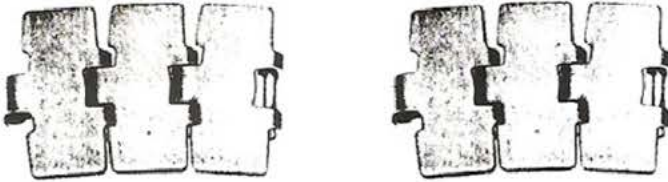

Paslanmaz çelikten Dönüşlü Şişe Kutu Yürütme Zincirleri

Hatve : 38.10 mm

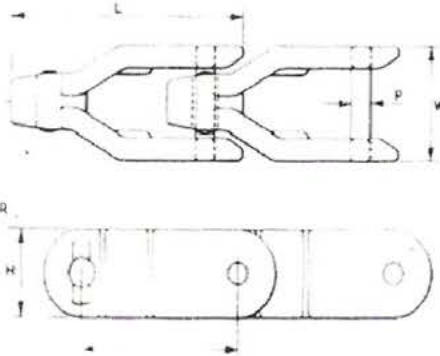

63.50 mm

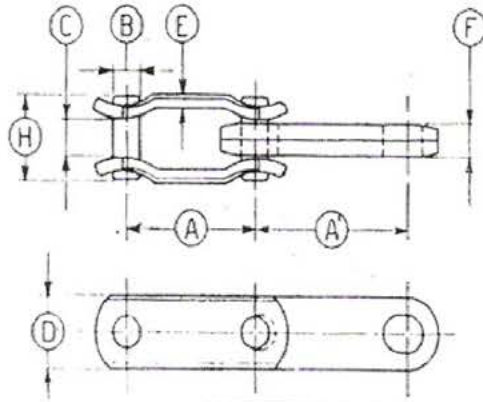

Dönüşlü Kasa Yürütme Zincirleri

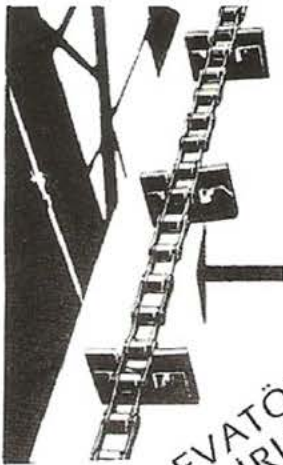

ELEVATÖR ZİNCİRLERİ

Pimleri Delikli Zincirler

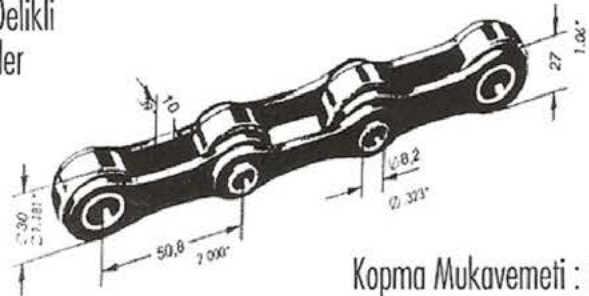

Kopma Mukavemeti : 5.000 kg.

Muhtelif Yönlere Dönüşlü Zincir



ZİRAİ TRANSMİSYON ZİNCİRLERİ

- BİÇER DÖVER
- BİÇER BAĞLAR
- TOHUM EKME - MİBZER
- ORAK MAKİNALARI
- V.S ...

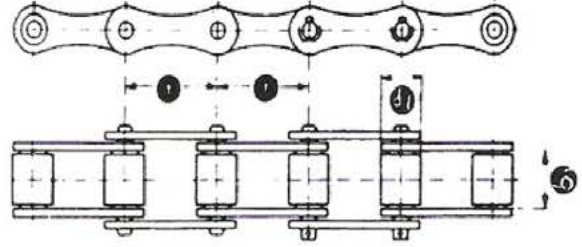

| Nr. | Norm Nr. | Hatve | | Makara Genişlik | | Makara Kotru | | Siklet | | Kopma Mukavemeti | |
|---------|----------|-------|-------|-----------------|------|--------------|-------|--------|-------|------------------|------|
| | | inç | mm | inç | mm | inç | mm | lb/ft. | Kg/mt | lb. | Kg. |
| AR 32 S | 32 | 1.15 | 29.21 | .625 | 15.9 | .45 | 11.43 | .55 | .76 | 1810 | 820 |
| AR 42 S | 42 | 1.375 | 34.93 | .75 | 19.1 | .562 | 14.27 | 1.19 | 1.65 | 6000 | 2720 |
| AR 38 | - | 1.5 | 38.1 | .75 | 19.1 | .48 | 12.1 | .95 | 1.30 | 6600 | 3000 |
| AR 52 S | 52 | 1.5 | 38.1 | .875 | 22.2 | .6 | 15.24 | 1.12 | 1.55 | 4000 | 1810 |
| AR 45 S | 45 | 1.63 | 41.4 | .875 | 22.2 | .6 | 15.24 | 1.07 | 1.43 | 4000 | 1810 |
| AR 55 S | 55 | 1.63 | 41.4 | .875 | 22.2 | .7 | 17.78 | 1.21 | 1.67 | 4000 | 1810 |
| AR 41 | - | 1.633 | 41.5 | .815 | 20.7 | .625 | 15.9 | 1.89 | 2.60 | 15400 | 7000 |
| AR 62 S | 62 | 1.65 | 41.91 | 1.0 | 25.4 | .75 | 19.05 | 1.45 | 2.00 | 6000 | 2720 |
| AR 77 S | 77 | 2.297 | 58.34 | .875 | 22.2 | .719 | 18.26 | 2.00 | 2.76 | 10000 | 4540 |
| AR 88 S | 88 | 2.609 | 66.27 | 1.125 | 28.6 | .9 | 22.86 | 2.24 | 3.10 | 10000 | 4540 |

PRESE ÇELİKTEN ZİNCİR BAKLALARI

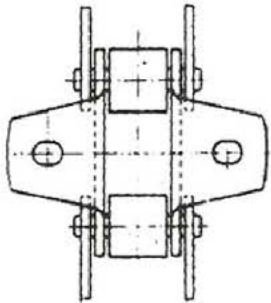

**KONVEYÖR
KULAKLI
ZİNCİRLER**

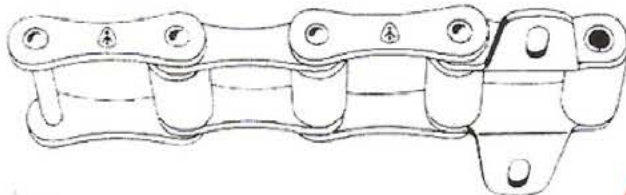

| Nr. | Hatve mm | Bir metrede bakla adedi | Kopma Mukave. kg. |
|---------|----------|-------------------------|-------------------|
| 25 | 23.0 | 44 | 430 |
| 32 | 29.5 | 34 | 750 |
| 42 | 35.0 | 29 | 1050 |
| 45 | 41.3 | 24 | 950 |
| 51 | 28.8 | 35 | 750 |
| 52 | 38.5 | 26 | 1220 |
| 55 | 41.3 | 24 | 1260 |
| 62-72.5 | 42.0 | 24 | 2000 |

SESSİZ ZİNCİRLER

60° İÇ
KLAVUZU

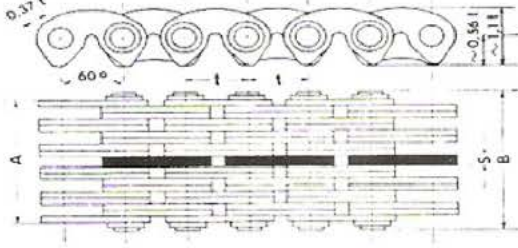

SafirZincir

| Nr. | t | | Plaka Kombinezon | A | B | S | F cm ² | Kopma Miktarı Kg. | Siklet Kg/mt |
|--------|--------|-------|---------------------|-------|-------|-------|----------------------|-------------------------|-----------------|
| | mm | inç | | | | | | | |
| 2101 | 8 | - | 1x2 | 8.2 | 12.8 | 1.2 | 0.08 | 500 | 0.40 |
| 2102 | | | 2x2 | 10.6 | 15.1 | | 0.11 | 660 | 0.49 |
| 2103 | | | 2x3 | 12.9 | 17.5 | | 0.14 | 835 | 0.59 |
| 2104 | | | 4x4 | 20 | 24.5 | | 0.22 | 1300 | 0.87 |
| 2105 | | | 4x5 | 22.2 | 26.7 | | 0.25 | 1500 | 0.97 |
| 2106 | | | 6x6 | 29.2 | 33.6 | | 0.34 | 2000 | 1.10 |
| 2107 | | | 6x7 | 31.6 | 36.1 | | 0.36 | 2200 | 1.25 |
| 2108 | | | 8x8 | 38.6 | 43 | | 0.45 | 2700 | 1.31 |
| 2109 | | | 8x9 | 40.9 | 45.5 | | 0.48 | 3000 | 1.38 |
| 2110 | 10 | - | 1x2 | 11.2 | 15.7 | 1.6 | 0.15 | 800 | 0.60 |
| 2111 | | | 2x2 | 14.4 | 19 | | 0.19 | 1050 | 0.77 |
| 2112 | | | 2x3 | 17.8 | 22.3 | | 0.24 | 1300 | 0.93 |
| 2113 | | | 4x4 | 27.1 | 31.7 | | 0.39 | 2100 | 1.40 |
| 2114 | | | 4x5 | 30.5 | 35.3 | | 0.44 | 2400 | 1.56 |
| 2115 | | | 6x6 | 39.8 | 44.5 | | 0.59 | 3100 | 2.08 |
| 2116 | | | 6x7 | 43 | 48 | | 0.64 | 3400 | 2.20 |
| 2117 | | | 8x8 | 52.7 | 57.3 | | 0.78 | 4200 | 2.65 |
| 2118 | | | 8x9 | 55.7 | 60.9 | | 0.83 | 4500 | 2.80 |
| 2121 | 12.7 | - | 1x2 | 11.2 | 16.1 | 1.6 | 0.20 | 900 | 0.80 |
| 2122 | | | 2x2 | 14.4 | 19.5 | | 0.27 | 1200 | 1.00 |
| 2123 | | | 2x3 | 17.8 | 22.9 | | 0.34 | 1500 | 1.20 |
| 2124 | | | 4x4 | 27.1 | 32.6 | | 0.54 | 2400 | 1.80 |
| 2125 | | | 4x5 | 30.3 | 35.2 | | 0.61 | 2800 | 2.00 |
| 2126 | | | 6x6 | 39.8 | 44.9 | | 0.81 | 3600 | 2.60 |
| 2127 | | | 6x7 | 43 | 48.4 | | 0.87 | 3900 | 2.80 |
| 2128 | | | 8x8 | 52.7 | 58.1 | | 1.08 | 4800 | 3.40 |
| 2129 | | | 8x9 | 55.7 | 61.2 | | 1.14 | 5100 | 3.60 |
| 2130 | | | 10x10 | 65.4 | 70.6 | | 1.35 | 6000 | 4.20 |
| 2141 | 15.875 | 5/8 | 1x2 | 16.7 | 22.2 | 2.3 | 0.33 | 2000 | 1.50 |
| 2142 | | | 2x2 | 21.4 | 27 | | 0.44 | 2600 | 1.50 |
| 2143 | | | 2x3 | 26.2 | 32.2 | | 0.56 | 3400 | 2.25 |
| 2143/4 | | | 3x3 | 31 | 37 | | 0.69 | 4100 | 2.70 |
| 2144 | | | 4x4 | 40.4 | 46.3 | | 0.89 | 5400 | 3.35 |
| 2145 | | | 4x5 | 45.2 | 51.4 | | 1.00 | 6000 | 3.70 |
| 2145/6 | | | 5x5 | 48.3 | 54 | | 1.12 | 6500 | 4.10 |
| 2146 | | | 6x6 | 59.4 | 65.7 | | 1.34 | 8500 | 4.80 |
| 2147 | | | 6x7 | 64.2 | 70.5 | | 1.45 | 8800 | 5.20 |
| 2148 | | | 8x8 | 78.4 | 85 | | 1.78 | 10600 | 6.65 |
| 2149 | | | 8x9 | 83.2 | 90 | | 1.90 | 11400 | 6.75 |
| 2150 | | | 10x10 | 97.4 | 104 | | 2.23 | 13100 | 8.10 |
| 2151 | | | 10x11 | 102.2 | 109 | | 2.34 | 13800 | 8.10 |
| 2161 | 19.05 | 3/4 | 1x2 | 21.3 | 27.2 | 3 | 0.50 | 2600 | 2.15 |
| 2162 | | | 2x2 | 26.7 | 33.1 | | 0.67 | 3500 | 2.70 |
| 2163 | | | 2x3 | 32.7 | 39 | | 0.84 | 4400 | 3.30 |
| 2163/4 | | | 3x3 | 38 | 44 | | 1.01 | 5500 | 4.00 |
| 2164 | | | 4x4 | 50.4 | 56.8 | | 1.35 | 7200 | 5.00 |
| 2165 | | | 4x5 | 56.4 | 63 | | 1.52 | 8100 | 5.60 |
| 2165/6 | | | 5x6 | 67 | 74 | | 1.69 | 9600 | 6.65 |
| 2166 | | | 6x6 | 74 | 80.5 | | 2.02 | 10800 | 7.30 |
| 2167 | | | 6x7 | 80 | 86.4 | | 2.19 | 11600 | 7.80 |
| 2168 | | | 8x8 | 97.7 | 104.1 | | 2.70 | 14500 | 9.50 |
| 2169 | | | 8x9 | 103.7 | 110.1 | | 2.87 | 15200 | 10.10 |
| 2170 | | | 10x10 | 121.4 | 127.8 | | 3.37 | 18000 | 11.80 |
| 2171 | | | 10x11 | 127.4 | 133.7 | | 3.54 | 19000 | 12.40 |
| 2181 | 25.4 | 1 | 1x2 | 27.5 | 34.8 | 4 | 0.94 | 4300 | 3.20 |
| 2182 | | | 2x2 | 35.3 | 42.6 | | 1.26 | 5700 | 4.00 |
| 2183 | | | 2x3 | 43.1 | 51.5 | | 1.58 | 7200 | 4.90 |
| 2183/4 | | | 3x3 | 51 | 58 | | 1.90 | 8500 | 5.60 |
| 2184 | | | 4x4 | 66.5 | 74 | | 2.52 | 11500 | 7.50 |
| 2185 | | | 4x5 | 74.4 | 82 | | 2.84 | 12900 | 8.30 |
| 2185/6 | | | 5x6 | 90 | 97 | | 3.17 | 15500 | 10.00 |
| 2186 | | | 6x6 | 97.8 | 105.2 | | 3.79 | 17200 | 11.00 |
| 2187 | | | 6x7 | 105.7 | 113 | | 4.10 | 18500 | 11.70 |
| 2186/7 | | | 7x8 | 121 | 129 | | 4.55 | 21500 | 13.30 |
| 2188 | | | 8x8 | 129.1 | 136.5 | | 5.05 | 23000 | 14.20 |
| 2189 | | | 8x9 | 137 | 144.5 | | 5.37 | 24500 | 15.00 |
| 2190 | | | 10x10 | 160.4 | 168 | | 6.31 | 28500 | 17.60 |
| 2191 | 10x11 | 168.3 | 175.5 | 6.63 | 30000 | 18.50 | | | |
| 2192 | 12x12 | 191.7 | 199 | 7.58 | 34000 | 21.00 | | | |

SESSİZ ZİNCİRLER

| Nr. | İ Havze | | Plaka Kombinezon | A | B | F cm2 | Kopma Mükemmeliyet Kg. | Sıklet Kg/mt |
|------|------------|-----|---------------------|-------|-------|----------|------------------------------|-----------------|
| | mm | inç | | | | | | |
| 1101 | 8 | | 1x2 | 7 | 13,6 | 1,11 | 750 | 0,42 |
| 1102 | | | 2x2 | 9,3 | 15,8 | 0,14 | 950 | 0,50 |
| 1103 | | | 2x3 | 11,8 | 18,2 | 0,17 | 1150 | 0,60 |
| 1104 | | | 3x4 | 16,4 | 22,9 | 0,23 | 1500 | 0,78 |
| 1105 | | | 4x5 | 21 | 27,5 | 0,28 | 1900 | 0,99 |
| 1106 | | | 5x6 | 25,6 | 32,3 | 0,34 | 2300 | 1,17 |
| 1107 | | | 6x7 | 30,4 | 37 | 0,40 | 2300 | 1,17 |
| 1108 | | | 7x8 | 35 | 41 | 0,45 | 3000 | 1,52 |
| 1131 | 9,525 | 3/8 | 2x3 | 16 | 23,4 | 0,29 | 1400 | 0,94 |
| 1132 | | | 3x3 | 19,3 | 26,7 | 0,34 | 1600 | 1,06 |
| 1133 | | | 3x4 | 22,4 | 30,1 | 0,39 | 1900 | 1,19 |
| 1134 | | | 4x4 | 25,6 | 33,3 | 0,44 | 2100 | 1,31 |
| 1135 | | | 4x5 | 28,7 | 36,2 | 0,49 | 2400 | 1,45 |
| 1136 | | | 5x5 | 32 | 40 | 0,54 | 2600 | 1,58 |
| 1110 | | | 1x2 | 9,6 | 17,3 | 0,20 | 1100 | 0,64 |
| 1111 | | | 2x2 | 12,7 | 20,3 | 0,24 | 1400 | 0,79 |
| 1112 | | | 2x3 | 16 | 23,4 | 0,29 | 1700 | 0,93 |
| 1113 | | | 3x4 | 22,4 | 30,1 | 0,39 | 2250 | 1,26 |
| 1114 | | | 4x5 | 28,7 | 36,2 | 0,49 | 2800 | 1,56 |
| 1115 | | | 5x6 | 35 | 42,8 | 0,59 | 3400 | 1,88 |
| 1116 | | | 6x7 | 41,2 | 49 | 0,69 | 4000 | 2,19 |
| 1117 | | | 7x8 | 47,6 | 55,6 | 0,79 | 4500 | 2,19 |
| 1118 | | | 8x9 | 54 | 62 | 0,88 | 5000 | 2,81 |
| 1121 | 12,7 | 1/2 | 1x2 | 9,6 | 17,8 | 0,27 | 1250 | 0,86 |
| 1122 | | | 2x2 | 12,7 | 21 | 0,34 | 1550 | 1,07 |
| 1123 | | | 2x3 | 16 | 24,3 | 0,40 | 1900 | 1,28 |
| 1124 | | | 3x4 | 22,4 | 30,7 | 0,54 | 2500 | 1,67 |
| 1125 | | | 4x5 | 28,7 | 36,9 | 0,67 | 3200 | 2,06 |
| 1126 | | | 5x6 | 35 | 43,4 | 0,81 | 3800 | 2,46 |
| 1127 | | | 6x7 | 41,2 | 49,6 | 0,94 | 4400 | 2,86 |
| 1128 | | | 7x8 | 47,6 | 56,2 | 1,08 | 5000 | 3,25 |
| 1129 | | | 8x9 | 54 | 62,5 | 1,21 | 5600 | 3,64 |
| 1130 | | | 10x10 | 63,9 | 72,1 | 1,35 | 7500 | 4,11 |
| 1141 | 15,875 | 5/8 | 1x2 | 14,3 | 25,3 | 0,45 | 2600 | 1,61 |
| 1142 | | | 2x2 | 18,8 | 30 | 0,56 | 3100 | 2,06 |
| 1143 | | | 2x3 | 23,6 | 34,7 | 0,67 | 4000 | 2,35 |
| 1144 | | | 3x4 | 32,9 | 44 | 0,89 | 5300 | 3,08 |
| 1145 | | | 4x5 | 42,3 | 53,5 | 1,12 | 6500 | 3,83 |
| 1146 | | | 5x6 | 52 | 62,9 | 1,34 | 7800 | 4,56 |
| 1147 | | | 6x7 | 61,7 | 72,6 | 1,56 | 9000 | 5,29 |
| 1148 | | | 7x8 | 70,5 | 82 | 1,78 | 10500 | 6,00 |
| 1149 | | | 8x9 | 79,9 | 91,3 | 2,01 | 11600 | 6,73 |
| 1150 | | | 9x10 | 89,3 | 100,7 | 2,23 | 13000 | 7,45 |
| 1161 | 19,05 | 3/4 | 1x2 | 17,7 | 30,3 | 0,67 | 3300 | 2,41 |
| 1162 | | | 2x2 | 23,5 | 36,1 | 0,84 | 4000 | 2,98 |
| 1163 | | | 2x3 | 29,5 | 42,2 | 1,01 | 5000 | 3,55 |
| 1164 | | | 3x4 | 41,9 | 54,4 | 1,35 | 6600 | 4,68 |
| 1165 | | | 4x5 | 53,1 | 65,8 | 1,69 | 8200 | 5,81 |
| 1166 | | | 5x6 | 64,8 | 77,5 | 2,02 | 9800 | 6,96 |
| 1167 | | | 6x7 | 76,6 | 89,9 | 2,36 | 11500 | 8,09 |
| 1168 | | | 7x8 | 88,2 | 101,2 | 2,70 | 13200 | 9,22 |
| 1169 | | | 8x9 | 100 | 113,3 | 3,04 | 15000 | 10,36 |
| 1170 | | | 9x10 | 111,5 | 125 | 3,37 | 16500 | 11,49 |
| 1171 | | | 10x11 | 123,2 | 137,2 | 3,71 | 18000 | 12,62 |
| 1181 | 25,4 | 1 | 1x2 | 23,5 | 38,3 | 1,26 | 5400 | 3,80 |
| 1182 | | | 2x2 | 31,1 | 46 | 1,58 | 6400 | 4,65 |
| 1183 | | | 2x3 | 38,9 | 54,1 | 1,89 | 8000 | 5,50 |
| 1184 | | | 3x4 | 54,6 | 70 | 2,52 | 11000 | 7,20 |
| 1185 | | | 4x5 | 70 | 85 | 3,16 | 13500 | 8,90 |
| 1186 | | | 5x6 | 85,5 | 101,3 | 3,79 | 16000 | 10,60 |
| 1187 | | | 6x7 | 101,1 | 116,2 | 4,42 | 19000 | 12,30 |
| 1188 | | | 7x8 | 116,6 | 132 | 5,05 | 22000 | 13,90 |
| 1189 | | | 8x9 | 132,2 | 147,6 | 5,68 | 24000 | 15,70 |
| 1190 | | | 9x10 | 147,7 | 163,4 | 6,32 | 27000 | 17,40 |
| 1191 | | | 10x11 | 163,3 | 179,1 | 6,95 | 30000 | 19,10 |
| 1192 | | | 11x12 | 178,9 | 195 | 7,58 | 32000 | 20,83 |

60° DIŞ
KLAUVUZU

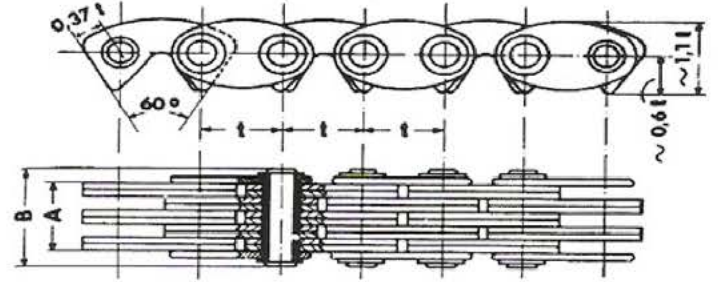

SafirZincir

FLEYER KALDIRMA ZİNCİRLERİ

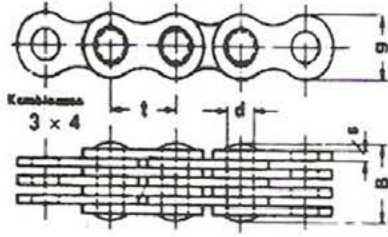

TAKVİYELİ

KOMBİNEZON ÖRNEKLERİ

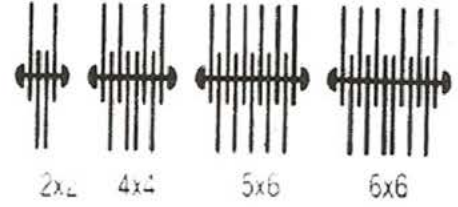

| t | Krom- binezon | d | B | s | g | F | PB | a | t | | Krom- binezon | d | B | s | g | F | PB | a | | | | | | | | | | |
|--------|------------------|------|-------|-------|-------|-------|------|------|-------|-------|------------------|--------|-------|--------|-----|-------|-------|-------|--------|-----|-------|------|------|---|----|------|-------|-------|
| | | | | | | | | | mm | inç | | | | | | | | | mm | inç | | | | | | | | |
| 6 | 1x2 | 1.85 | 3.4 | 0.60 | 5.5 | 0.011 | 300 | 0.06 | 19.05 | 3/4" | 2x2 | 5.72 | 10.3 | 1.80 | 15 | 0.206 | 3000 | 0.59 | | | | | | | | | | |
| | 2x2 | | 4.0 | | | 0.022 | 400 | 0.08 | | | | | 3x4 | | | 15.7 | 0.310 | 4500 | 1.00 | | | | | | | | | |
| | 3x4 | | 5.8 | | | 0.033 | 700 | 0.13 | | | | | 4x4 | | | 17.6 | 0.412 | 6000 | 1.15 | | | | | | | | | |
| | 4x4 | | 6.4 | | | 0.044 | 800 | 0.15 | | | | | 5x6 | | | 23.0 | 0.515 | 8000 | 1.55 | | | | | | | | | |
| | 5x6 | | 8.2 | | | 0.055 | 1100 | 0.21 | | | | | 6x6 | | | 25.0 | 0.618 | 9000 | 1.70 | | | | | | | | | |
| | 6x6 | | 8.8 | | | 0.066 | 1200 | 0.23 | | | | | 7x8 | | | 30.3 | 0.720 | 10500 | 2.10 | | | | | | | | | |
| | | | | | | | | | | | | | 8x8 | | | 32.2 | 0.824 | 12000 | 2.24 | | | | | | | | | |
| | | | | | | | | | | | | | 9x10 | | | 37.6 | 0.927 | 14000 | 2.67 | | | | | | | | | |
| | | | | | | | | | | | | | 10x10 | | | 39.5 | 1.030 | 15000 | 2.78 | | | | | | | | | |
| | 8 | | 1x2 | | | 2.55 | 5.0 | 1.00 | | | | | 7.2 | | | 0.026 | 600 | 0.12 | 25.4 | 1" | 2x2 | 8.27 | 17.0 | 3 | 20 | 0.50 | 6800 | 1.56 |
| 2x2 | | 6.0 | 0.051 | 800 | 0.16 | | 3x4 | | 27.0 | 0.75 | 8500 | 2.67 | | | | | | | | | | | | | | | | |
| 3x4 | | 9.1 | 0.076 | 1400 | 0.28 | | 4x4 | | 29.5 | 1.00 | 13500 | 3.04 | | | | | | | | | | | | | | | | |
| 4x4 | | 10.2 | 0.102 | 1600 | 0.32 | | 5x6 | | 39.0 | 1.25 | 18300 | 4.15 | | | | | | | | | | | | | | | | |
| 5x6 | | 13.3 | 0.127 | 2200 | 0.44 | | 6x6 | | 42.0 | 1.50 | 21000 | 4.53 | | | | | | | | | | | | | | | | |
| 6x6 | | 14.4 | 0.153 | 2400 | 0.48 | | 7x8 | | 51.0 | 1.75 | 23500 | 5.63 | | | | | | | | | | | | | | | | |
| 7x8 | | 17.5 | 0.179 | 3000 | 0.60 | | 8x8 | | 54.0 | 2.00 | 27500 | 5.99 | | | | | | | | | | | | | | | | |
| 8x8 | | 18.6 | 0.204 | 3200 | 0.64 | | | | | | | | | | | | | | | | | | | | | | | |
| 10 | | 1x2 | 3.00 | 6.3 | 1.50 | | 9.0 | | 0.045 | 750 | 0.23 | 31.75 | | 1 1/4" | 2x2 | 10.17 | 20.0 | | | | | | | | | 0.77 | 10500 | 2.01 |
| | | 2x2 | | 7.9 | | | | | 0.090 | 1000 | 0.30 | | | | | | 3x4 | | | | | | | | | 32.0 | 1.16 | 15500 |
| | 3x4 | 12.6 | | 0.135 | | 1750 | | 0.53 | 4x4 | 36.0 | 1.54 | | 21000 | | | | 3.93 | | | | | | | | | | | |
| | 4x4 | 14.2 | | 0.180 | | 2000 | | 0.60 | 5x6 | 48.0 | 1.93 | | 28500 | | | | 5.40 | | | | | | | | | | | |
| | 5x6 | 18.8 | | 0.225 | | 2750 | | 0.83 | 6x6 | 52.0 | 2.32 | | 31500 | | | | 5.86 | | | | | | | | | | | |
| | 6x6 | 20.4 | | 0.270 | | 3000 | | 0.91 | 7x8 | 63.0 | 2.70 | | 36800 | | | | 7.28 | | | | | | | | | | | |
| | 7x8 | 25.0 | | 0.315 | | 3750 | | 1.14 | 8x8 | 67.0 | 3.09 | | 42000 | | | | 7.78 | | | | | | | | | | | |
| | 8x8 | 26.6 | | 0.360 | | 4000 | | 1.23 | | | | | | | | | | | | | | | | | | | | |
| | 12.7 | 2x2 | | 4.45 | | 8.8 | | 1.65 | 11 | 0.147 | 1900 | | 0.41 | | | | 38.1 | | 1 1/2" | 2x2 | 14.63 | 26.5 | | 5 | 34 | 1.43 | 17500 | 4.18 |
| | | 3x4 | | | | 13.8 | | | | 0.220 | 2900 | | 0.70 | | | | | | | | | 3x4 | | | | 42.0 | 2.15 | 26500 |
| 4x4 | | 15.5 | 0.294 | | 3600 | 0.79 | 4x4 | | | 47.0 | 2.87 | 35400 | 8.84 | | | | | | | | | | | | | | | |
| 5x6 | | 20.5 | 0.367 | | 4750 | 1.08 | 5x6 | | | 62.5 | 3.59 | 46800 | 11.20 | | | | | | | | | | | | | | | |
| 6x6 | | 22.0 | 0.440 | | 5700 | 1.18 | 6x6 | | | 67.5 | 4.30 | 54000 | 12.20 | | | | | | | | | | | | | | | |
| 7x8 | | 27.0 | 0.514 | | 6700 | 1.46 | 7x8 | | | 83.0 | 5.02 | 63800 | 15.20 | | | | | | | | | | | | | | | |
| 8x8 | | 28.8 | 0.587 | | 7600 | 1.56 | 8x8 | | | 88.0 | 5.74 | 70000 | 16.20 | | | | | | | | | | | | | | | |
| 9x10 | | 33.8 | 0.670 | | 8700 | 1.85 | | | | | | | | | | | | | | | | | | | | | | |
| 10x10 | | 35.6 | 0.735 | | 9400 | 1.94 | | | | | | | | | | | | | | | | | | | | | | |
| 15.875 | | 2x2 | 5.08 | | 9.8 | 1.70 | 13 | | | 0.172 | 2600 | 0.50 | 44.45 | 1 3/4" | 2x2 | 15.87 | | 35.0 | | | | 6 | 43 | | | 2.24 | 26500 | 6.73 |
| | 3x4 | 15.0 | | 0.259 | 4000 | | | 0.83 | 3x4 | 53.0 | 3.20 | 44200 | | | | | 11.50 | | | | | | | | | | | |
| | 4x4 | 16.8 | | 0.345 | 5200 | | | 0.96 | 4x4 | 59.0 | 4.27 | 53000 | | | | | 13.10 | | | | | | | | | | | |
| | 5x6 | 22.0 | | 0.432 | 6600 | | | 1.28 | 5x6 | 77.0 | 5.34 | 68400 | | | | | 17.80 | | | | | | | | | | | |
| | 6x6 | 23.8 | | 0.518 | 7800 | | | 1.39 | 6x6 | 84.0 | 6.40 | 80000 | | | | | 19.50 | | | | | | | | | | | |
| | 7x8 | 28.8 | | 0.605 | 9000 | | | 1.72 | 7x8 | 102.0 | 7.48 | 94000 | | | | | 24.10 | | | | | | | | | | | |
| | 8x8 | 30.6 | | 0.690 | 10200 | | | 1.85 | 8x8 | 108.0 | 8.55 | 105000 | | | | | 25.80 | | | | | | | | | | | |
| | 9x10 | 35.7 | | 0.778 | 11500 | | | 2.18 | | | | | | | | | | | | | | | | | | | | |
| | 10x10 | 37.5 | | 0.965 | 12700 | | | 2.30 | | | | | | | | | | | | | | | | | | | | |

ZİNCİRLERİN BAKIMI

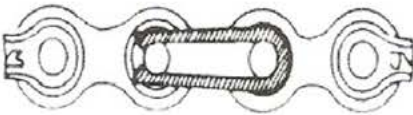
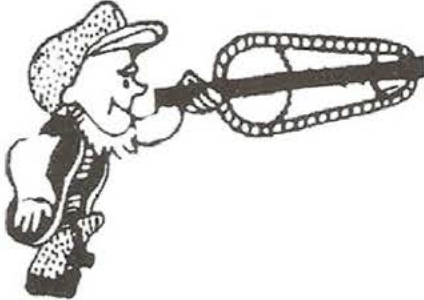

Zaman zaman zinciri benzin ve gazla batırıp bir kaç saat bırakınız.

Zinciri sağa, sola hareket ettirip temizleyiniz.

Sert bir fırça ile fırçalayınız. Kirleri tamamen yok etmek için tekrar Benzin veya Gazla yıkayınız. Yıkandıktan sonra, ılık bir yağ hazırlayarak, Bilhassa yağın makaraların içine nüfuz etmesine dikkat ediniz.

Yağ damlalarının iyice akmasını bekleyiniz.

Dişlileri de temizledikten sonra, kontrol ediniz.

Dişlilerin, karşılıklarının aynı hizada olmasını mutlaka temin ediniz.

Zincir kilidini ve yayı resimde görüldüğü şekilde takınız.

YAĞLAMA METODLARI

Zincirlerin yağlanması 4 şekilde olur.

- 1) Alçak devirli için ELLE
- 2) Orta devirli için DAMLALIKLA
- 3) Hızlı devirli için YAĞ BANYOSUNDA
- 4) Yüksek devirli için TAZYİKLE YAĞLAMA



SafirZincir